



ALLIED MACHINE
& ENGINEERING

WOHLHAUPTER®

Holemaking Solutions for Today's Manufacturing



Drilling



Reaming



Burnishing



Threading



Specials



Wohlhaupter®

▶ *BORING*

Modular Tool Holders

WOHLHAUPTER®

SECTION

B10-I

Modular Tool Holders

Wohlhaupter® Modular Tool Holders

Adapter Sleeves | Drill Chucks | Collet Chucks | Milling Arbors | Holding Arbors | Hydraulic Clamping Chucks
Tapping Chucks | Boring Bar Blanks



Clamping Tools with MVS Connection

Wohlhaupter offers a complete range of tool holders that incorporates the MVS connection. Our clamping tools allow for smaller MVS tools to connect and provide a quick and inexpensive alternative to special tooling. Many of the clamping tools also feature coolant-through capabilities.

Your safety and the safety of others is very important. This catalogue contains important safety messages. Always read and follow all safety precautions.



This triangle is a safety hazard symbol. It alerts you to potential safety hazards that can cause tool failure and serious injury.

When you see this symbol in the catalogue, look for a related safety message that may be near this triangle or referred to in the nearby text.

There are safety signal words also used in the catalogue. Safety messages follow these words.

⚠ WARNING

WARNING (shown above) means that failure to follow the precautions in this message could result in tool failure and serious injury.

NOTICE means that failure to follow the precautions in this message could result in damage to the tool or machine but not result in personal injury.

NOTE and **IMPORTANT** are also used. These are important that you read and follow but are not safety-related.

Visit www.alliedmachine.com for the most up-to-date information and procedures.

Applicable Industries



Aerospace



Agriculture



Automotive



Firearms



General
Machining



Oil & Gas



Renewable
Energy

Reference Icons

The following icons will appear throughout the catalogue to help you navigate between products.

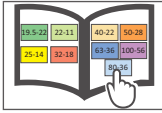

MVS Connection Colour Guide

Detailed instructions and information regarding the MVS connection(s)

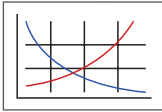

Recommended Cutting Data

Speed and feed recommendations for optimum and safe boring



Through Coolant Option

Indicates that the product is through coolant

Modular Tool Holders Table of Contents

Adapter Side Lock for Cylindrical Shanks	2
Drill Chucks	3
Collet Chucks	4
Milling Machine Arbors	5
Holding Arbors for Milling Cutters	6
Clamping and Tapping Chucks	7
Boring Bar Blanks	8
Accessories for Adapter Sleeves	
Thread Pins and Ball Pressure Screws	9
Adapter Sleeves for Tap Shanks	10
Micro Clamping Chucks	11
Accessories for Drill Chucks	12
Collet Chucks for Erickson System	13
Accessories for Collet Chucks	14 - 30
Sealing Disks for Collet Chucks	31 - 32
Accessories for Milling Machine Arbors	33
Reducing Sleeves for Hydraulic Clamping Chucks	34
Quick Change Adapters	35 - 38
Service Keys	39

Adapter Side Lock for Cylindrical Shanks DIN 1835B

Clamping Diameter Range: 6.00 mm - 40.00 mm

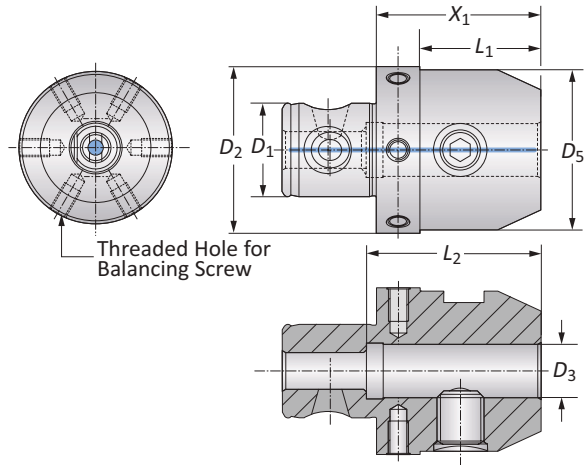

MVS Connection	Clamping Range	Adapter Sleeve				Weight	Balancing Screw	Part No.
		$D_2 D_1$	D_3	X_1	L_1			
32 - 18	6.00	36.00	23.00	40.00	25.00	0.20 (kg)	M5 x .8 x 6	228022
32 - 18	8.00	36.00	23.00	40.00	28.00	0.20 (kg)	M5 x .8 x 6	228023
32 - 18	10.00	48.00	–	44.00	35.00	0.30 (kg)	M5 x .8 x 6	228024
40 - 22	12.00	52.00	–	49.00	42.00	0.50 (kg)	M5 x .8 x 8	228025
40 - 22	14.00	54.00	–	49.00	44.00	0.60 (kg)	M5 x .8 x 8	228026
50 - 28	6.00	36.00	23.00	40.00	25.00	0.40 (kg)	M6 x 1 x 10	162015
50 - 28	8.00	36.00	23.00	40.00	28.00	0.40 (kg)	M6 x 1 x 10	162016
50 - 28	10.00	44.00	31.00	44.00	35.00	0.50 (kg)	M6 x 1 x 10	162017
50 - 28	12.00	44.00	31.00	49.00	42.00	0.50 (kg)	M6 x 1 x 10	162018
50 - 28	16.00	49.00	36.00	52.00	48.00	1.00 (kg)	M6 x 1 x 10	162019
50 - 28	18.00	49.00	36.00	52.00	48.00	1.00 (kg)	M6 x 1 x 10	228014
50 - 28	20.00	60.00	–	54.00	52.00	1.20 (kg)	M6 x 1 x 10	162020
63 - 36	20.00	49.00	36.00	54.00	52.00	1.10 (kg)	M6 x 1 x 10	161024
63 - 36	25.00	75.00	–	59.00	63.00	1.90 (kg)	M6 x 1 x 15	161026
63 - 36	32.00	75.00	–	63.00	72.00	2.20 (kg)	M6 x 1 x 15	161027
80 - 36	40.00	85.00	–	73.00	80.00	2.50 (kg)	M6 x 1 x 15	161028

NOTE: Balanced 10 gmm/kg.

NOTE: When using a ball pressure screw instead of a thread pin, it's similar to DIN 1835E, without axial adjustment.

See ball pressure screws on page B10-I: 9.

B10-M: 12-13

B10: VI-VII

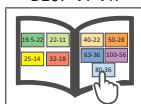
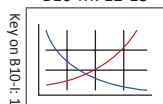

Ⓜ = Metric (mm)

Drill Chucks for Clockwise & Counterclockwise Rotation

Clamping Diameter Range: 0.50 mm - 16.00 mm

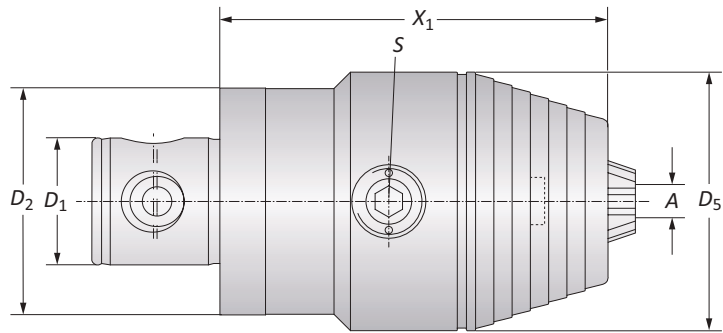

MVS Connection	Clamping Range	Drill Chuck			Weight	Part No.	
		D_2 D_1	A	X_1			D_5
Ⓜ	50 - 28	0.50 - 13.00	80.00	50.00	s6 / B	1.10 (kg)	209088
	50 - 28	2.50 - 16.00	85.00	57.00	s6 / B	1.30 (kg)	209089
	63 - 36	0.50 - 13.00	80.00	50.00	s6 / B	1.30 (kg)	209090
	63 - 36	2.50 - 16.00	85.00	57.00	s6 / B	1.50 (kg)	209091

A
B
C
D
E
F
G
H
I
J
K
L
M
INDEX

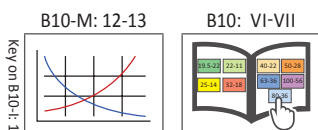

Ⓜ = Metric (mm)

Collet Chucks ISO 10897 (DIN 6388) | ISO 15488 (DIN 6499)

Clamping Diameter Range: 2.00 mm - 32.00 mm

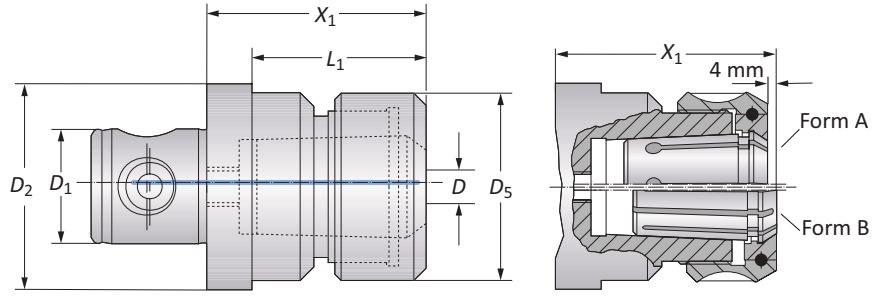

Collet Chucks ISO 10897 (DIN 6388) | Diameter Range: 2.00 mm - 32.00 mm

MVS Connection	Clamping Range	Nominal Size	Collet Chuck			Weight	Part No.
			X_1^*	L_1	D_5		
$D_2 D_1$	D						
40 - 22	2.00 - 16.00	16	64.00	–	43.00	0.50 (kg)	209082
50 - 28	2.00 - 16.00	16	63.00	50.00	43.00	0.90 (kg)	162011
m 50 - 28	2.00 - 25.00	25	74.00	–	60.00	1.00 (kg)	209083
63 - 36	2.00 - 25.00	25	74.00	–	60.00	1.40 (kg)	161016
63 - 36	4.00 - 32.00	32	89.00	–	72.00	1.80 (kg)	161098

* X_1 Clamping nut with ball-bearing.

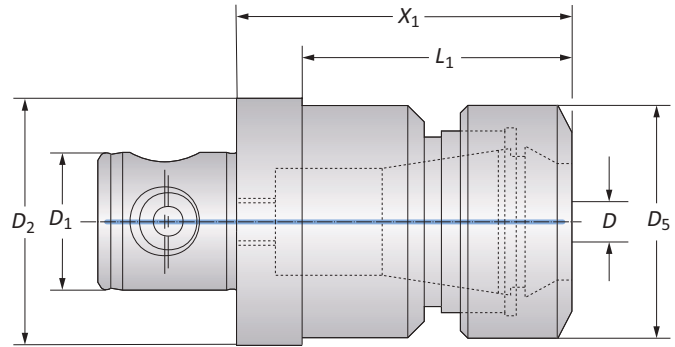

Collet Chucks ISO 15488 (DIN 6499) | Diameter Range: 1.00 mm - 26.00 mm

MVS Connection	Clamping Range	Nominal Size	Collet Chuck			Weight	Part No.
			X_1^*	L_1	D_5		
$D_2 D_1$	D						
32 - 18	1.00 - 10.00	ER 16	54.00	4100	28.00	0.20 (kg)	228020
40 - 22	2.00 - 16.00	ER 25	75.00	–	42.00	0.60 (kg)	228021
m 50 - 28	2.00 - 16.00	ER 25	75.00	62.00	42.00	0.80 (kg)	228003
50 - 28	2.00 - 20.00	ER 32	76.00	–	50.00	0.80 (kg)	228004
63 - 36	2.00 - 20.00	ER 32	76.00	63.00	50.00	1.20 (kg)	228007
63 - 36	4.00 - 26.00	ER 40	88.00	–	63.00	1.20 (kg)	228006

* X_1 Clamping nut with sliding ring.

B10-M: 12-13

B10: VI-VII

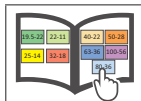
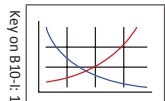

m = Metric (mm)

Milling Machine Arbors

For Milling Cutters with Longitudinal or Transverse Drive | Shell Mill Adapter Range: 13.00 mm - 40.00 mm

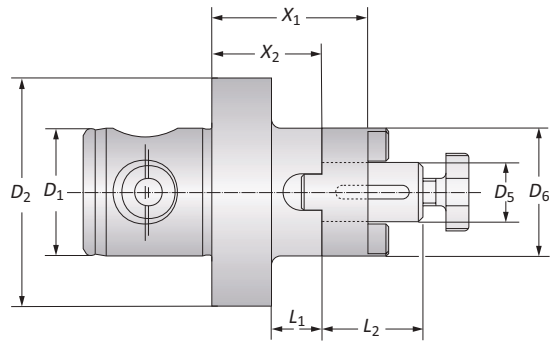

MVS Connection	Adapter Range	Milling Arbor						Weight	Part No.
		D_2 D_1	D_5	X_1	X_2	L_1	L_2		
m	50 - 28	13.00	34.00	24.00	11.00	22.00	28.00	0.40 (kg)	162002
	50 - 28	16.00	40.00	30.00	17.00	27.00	32.00	0.50 (kg)	162003
	50 - 28	22.00	40.00	28.00	15.00	31.00	40.00	0.60 (kg)	162004
	63 - 36	16.00	40.00	30.00	17.00	27.00	32.00	0.80 (kg)	161002
	63 - 36	22.00	40.00	28.00	15.00	31.00	40.00	0.90 (kg)	161003
	63 - 36	27.00	40.00	28.00	15.00	33.00	48.00	1.10 (kg)	161004
	63 - 36	32.00	40.00	26.00	13.00	38.00	58.00	1.30 (kg)	161005
	80 - 36	40.00	53.00	39.00	-	41.00	70.00*	2.60 (kg)	161006

* \varnothing 70.00 mm with clutch drive ring.

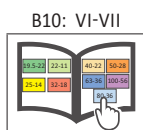
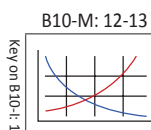

m = Metric (mm)

Holding Arbors for Milling Cutters

Central Coolant Feed | Shell Mill Adapter Range: 16.00 mm - 40.00 mm

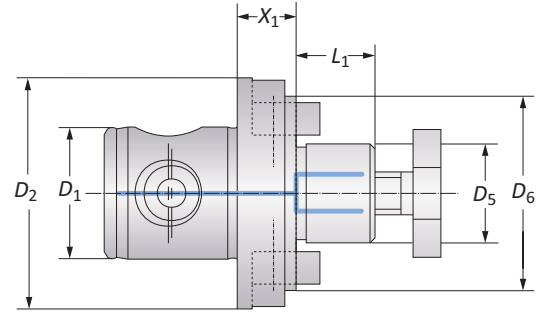
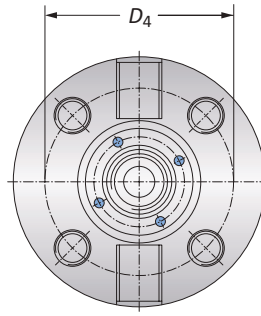

MVS Connection	Adapter Range	Holding Arbor				Weight	Part No.
		D_2 D_1	D_5	X_1	L_1		
50 - 28	16.00	16.00	17.00	–	40.00	0.40 (kg)	162032
50 - 28	22.00	16.00	19.00	–	50.00	0.50 (kg)	162033
m 63 - 36	27.00	16.00	21.00	–	60.00	0.80 (kg)	161082
80 - 36	32.00	16.00	24.00	–	78.00	1.10 (kg)	209080
80 - 36	40.00	19.00	27.00	66.70	89.00	1.50 (kg)	209081

NOTE: See page B10-G: 15 for holding arbor with MVS 100 - 56 connection.

B10-M: 12-13

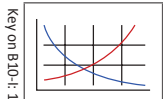

B10: VI-VII

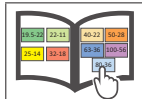



m = Metric (mm)

Clamping Chucks | Tapping Chucks

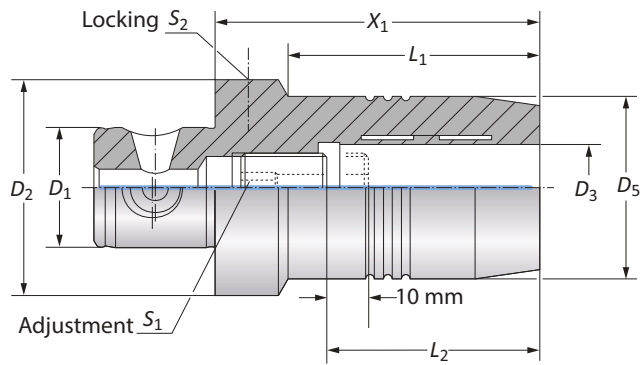
Clamping Range: 20.00 mm





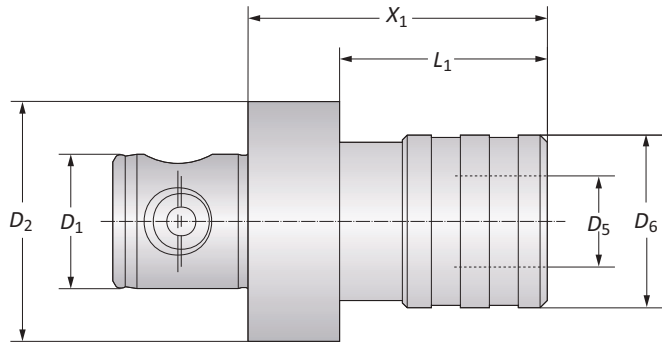

Though Coolant Hydraulic Clamping Chucks

MVS Connection	Clamping Range	Clamping Chucks							Weight	Part No.
		D_2 D_1	D_3	X_1	D_5	L_1	L_2	S_1		
 50 - 28	20.00	75.00	42.00	58.00	51.00	s6	s5	0.80 (kg)	209044	
 63 - 36	20.00	75.00	42.00	53.00	51.00	s5	s5	1.10 (kg)	209045	

Note: Balanced corresponds to a specific residual imbalance of ≤ 10 gmm/kg.



Tapping Chucks (Non-Coolant)

MVS Connection	Quick Change Adapters		Tapping Chucks				Length Compensation		Weight	Part No.
	For Taps	Nominal Size	X_1	L_1	D_5	D_6	Pressure	Tension		
 50 - 28	M 3 - M 12	1	62.00	49.00	19.00	41.50	7.50	7.50	0.70 (kg)	209098
 50 - 28	M 6 - M 20	2	94.00	-	31.00	60.30	10.00	10.00	1.10 (kg)	209099
 63 - 36	M 3 - M 12	1	56.00	43.00	19.00	41.50	7.50	7.50	0.80 (kg)	231005
 63 - 36	M 6 - M 20	2	80.00	67.00	31.00	60.30	10.00	10.00	1.30 (kg)	231006
 63 - 36	M 14 - M 33	3	152.00	-	48.00	86.00	17.50	17.50	4.10 (kg)	231007

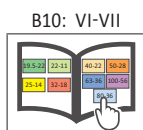
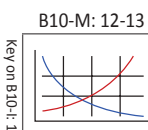

 = Metric (mm)

Boring Bar Blanks

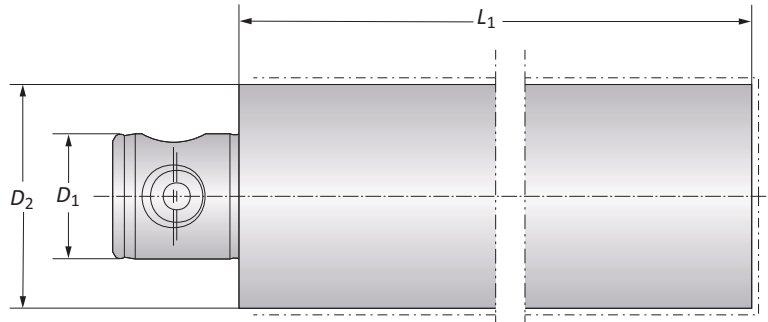

NOTE: The blanks are unhardened and unground in areas marked

MVS Connection	Boring Bar Blanks		
$D_2 D_1$	L_1	Weight	Part No.
50 - 28	160.00	2.60 (kg)	166103
63 - 36	160.00	4.20 (kg)	166104
80 - 36	160.00	6.60 (kg)	166105

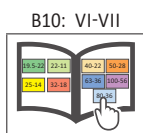
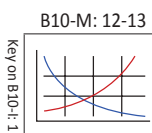

m = Metric (mm)

Accessories for Adapter Sleeves

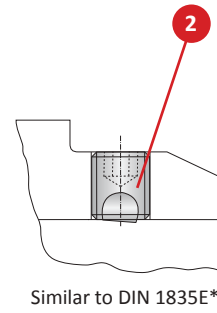
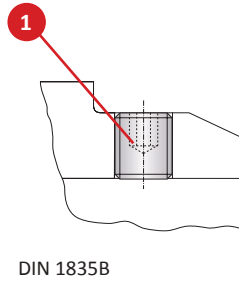
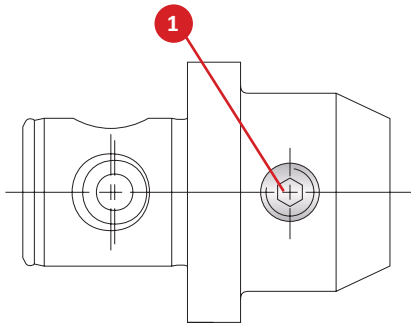

Clamping Diameter	1 Thread Pin		2 Ball Pressure Screw		
	Part No.	Service Key	Part No.	Service Key	Thread
6.00	115680	s3 / B	315788	s3 / B	M6 x 1
8.00	115681	s4 / B	315789	s4 / B	M8 x 1.25
10.00	115682	s5 / B	515535	s5 / B	M10 x 1.5
12.00	115683	s6 / B	315790	s6 / B	M12 x 1.75
14.00	115683	s6 / B	315790	s6 / B	M12 x 1.75
16.00	115684	s6 / B	515675	s6 / B	M14 x 2
18.00	115684	s6 / B	515675	s6 / B	M14 x 2
20.00	115685	s8 / B	515676	s8 / B	M16 x 2
25.00	115686	s10 / B	515677	s10 / B	M18 x 2 (2x)
32.00	115687	s10 / B	515678	s10 / B	M20 x 2 (2x)
40.00	115687	s10 / B	515678	s10 / B	M20 x 2 (2x)

*Without axial adjustment.

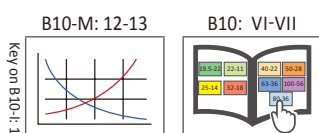

 = Metric (mm)

Accessories for Adapter Sleeves

Adapter Sleeve for Tap Shanks Suitable for Reduction Sleeves with Shanks to DIN 1835-B

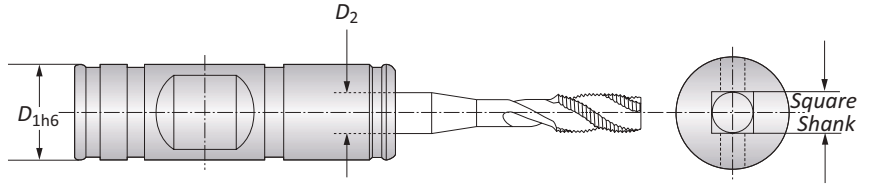

Adapter Sleeves			
	D_{1h6}	D_2 x Square Shank	Part No.
	8.00	2.10 x 2.50	271190
	8.00	2.10 x 2.80	271191
	10.00	2.70 x 3.50	271192
	10.00	3.00 x 4.00	271193
	10.00	3.40 x 4.50	271194
	12.00	4.90 x 6.00	271195
	14.00	5.50 x 7.00	271196
	14.00	6.20 x 8.00	271197
	16.00	7.00 x 9.00	271198
	16.00	8.00 x 10.00	271199
m	18.00	9.00 x 11.00	271200
	20.00	9.00 x 12.00	271201
	25.00	11.00 x 14.00	271202
	25.00	12.00 x 16.00	271203
	32.00	14.50 x 18.00	271204
	32.00	16.00 x 20.00	271205
	32.00	18.00 x 22.00	271206
	40.00	20.00 x 25.00	271207
	40.00	22.00 x 28.00	271208
	50.00	24.00 x 32.00	271209
	50.00	29.00 x 36.00	271210
	50.00	32.00 x 40.00	271211

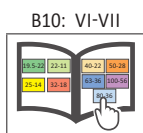
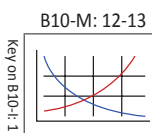

m = Metric (mm)

Accessories for Adapter Sleeves

Adapter Sleeve for Tap Shanks Suitable for Reduction Sleeves with Shanks to DIN 1835-B

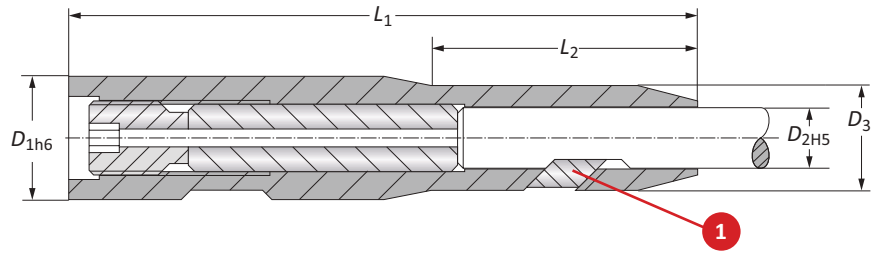

Micro Clamping Chucks					1 Clamping Wedge	
D_{1h6}	D_{2H5}	D_3	L_1	L_2	Part No.	Part No.
16.00	6.00	12.00	100.00	40.00	219170	219070
16.00	8.00	14.00	100.00	45.00	219171	219071
20.00	10.00	17.00	100.00	43.00	219172	219072
25.00	12.00	20.00	110.00	39.00	219173	219073
25.00	14.00	22.00	110.00	46.00	219174	219074
32.00	16.00	25.00	125.00	45.00	219174	219075
32.00	18.00	27.00	130.00	54.00	219174	219076
32.00	20.00	30.00	130.00	62.00	219175	219077

NOTE: Clamping chucks are used in reduction sleeves for clamping tools with cylindrical shanks to DIN 1835-B (Fig. 1). The chucks' design allows the use of standard tools versus ordering special tools (Fig. 2).

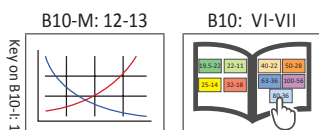
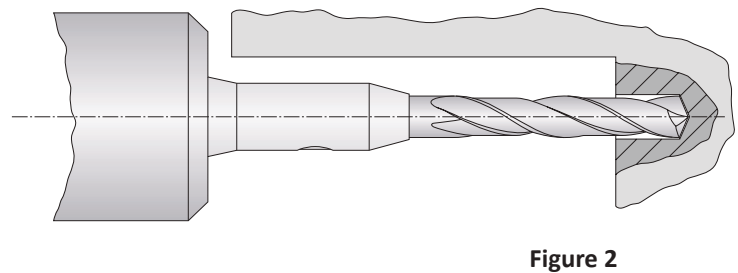
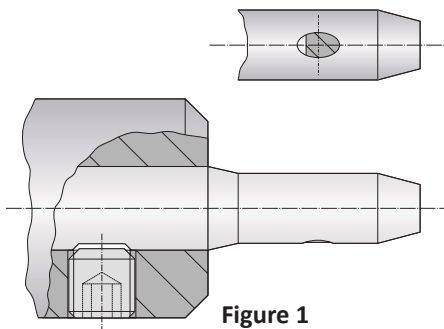

m = Metric (mm)

Accessories for Drill Chucks

Service Keys | Gaskets | Assembly Tool

Service Keys for Drill Chucks

Service Key		Tightening Torque Nm	Part No.
Service Key	Type		
2.50	B	15	415577
6.00	B	15	115578

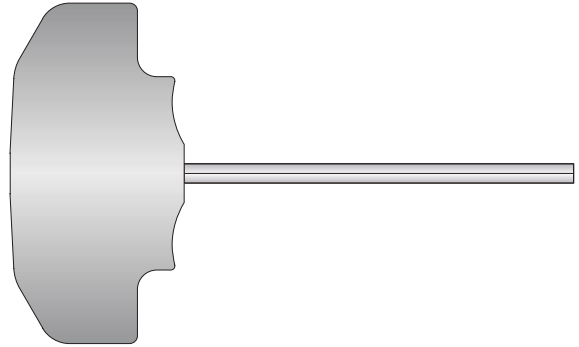

Gaskets for Drill Chucks

m	Gasket		Part No.
	Gasket Diameter	Clamping Diameter	
	3.00 - 6.00	0.50 - 13.00	387113
	6.00 - 13.00	0.50 - 13.00	387114
	3.00 - 6.00	2.50 - 16.00	387115
	6.00 - 16.00	2.50 - 16.00	387116

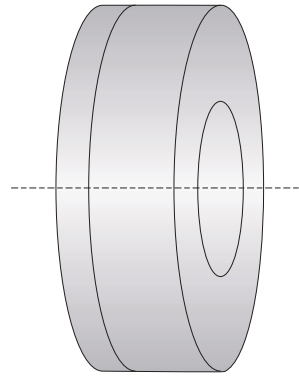

Assembly Tool for Gasket

Part No.
387112

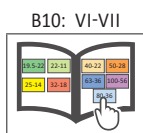
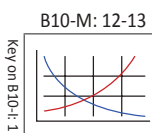
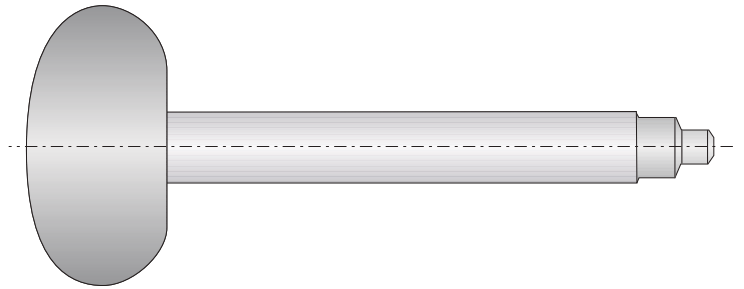

m = Metric (mm)

Collet Chucks for Erickson System | Cylindrical Collet Chucks for ISO 15488 (DIN 6499) Collets

Diameter Range: 1.00 mm - 10.00 mm

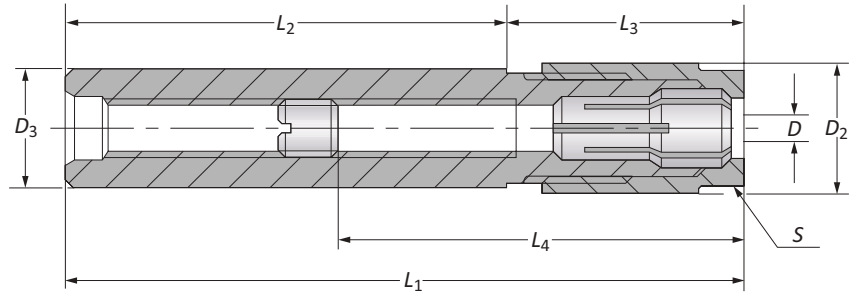

Collet Chucks for Erickson System

Nominal Size	Clamping Range	Collet Chuck								Service Key	Weight	Part No.
		D_2	D_3	L_1	L_2	L_3	L_4 Min	L_4 Max				
m	6	0.50 - 6.00	14.00	12.50	109.00	76.00	33.00	38.00	100.00	13	0.20 (kg)	162080
	6	0.50 - 6.00	14.00	12.50	173.00	140.00	33.00	38.00	162.00	13	0.20 (kg)	162081
	10	0.50 - 10.00	21.00	20.00	117.00	76.00	41.00	40.00	103.00	19	0.30 (kg)	162082
	10	0.50 - 10.00	21.00	20.00	181.00	140.00	41.00	40.00	167.00	19	0.30 (kg)	162083

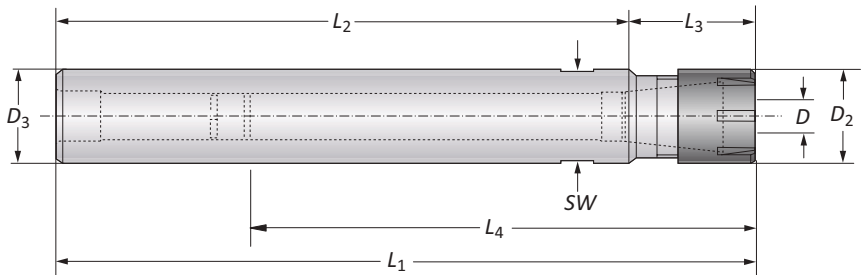

Cylindrical Collet Chucks for ISO 15488 (DIN 6499) Collets

Nominal Size	Collet Chuck									Hex Size	Part No.
	D	D_2	D_3	L_1	L_2	L_3	L_4 Min	L_4 Max	SW		
m	ER 8	1.00 - 5.00	12.00	8.00	126.00	100.00	26.00	36.50	36.50	09	209054
	ER 8	1.00 - 5.00	12.00	12.00	166.00	140.00	26.00	36.50	36.50	09	209055
	ER 11	1.00 - 7.00	16.00	16.00	106.50	80.00	26.50	23.00	65.00	11	209056
	ER 11	1.00 - 7.00	16.00	16.00	166.50	140.00	26.50	23.00	65.00	11	209057
	ER 16	1.00 - 10.00	22.00	20.00	118.50	80.00	38.50	33.00	102.00	17	209058
	ER 16	1.00 - 10.00	22.00	20.00	178.50	140.00	38.50	33.00	123.00	17	209059

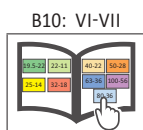
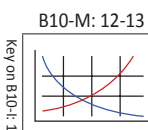

m = Metric (mm)

Accessories for Collet Chucks

Diameter Range: 0.50 mm - 10.00 mm

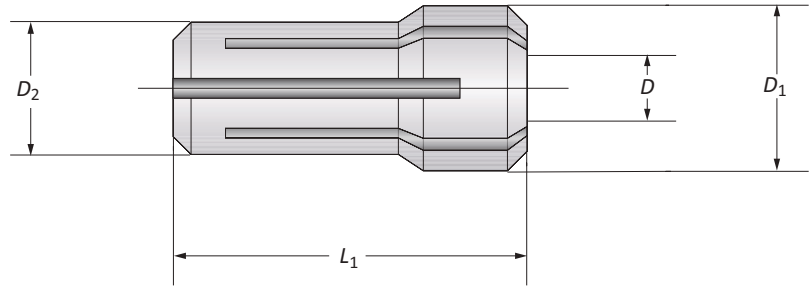

Collet Sets for Erickson System

Metric	Nominal Size	Standard-No.	Set				Part No.
			D_1	D_2	L_1	D	
	6	416 E	9.50	7.62	25.50	0.50 - 6.00	071016
	10	417 E	13.50	11.43	30.40	0.50 - 10.00	071017

Collets for Erickson System

Metric	Collet	Diameter Range	Part No.
	Nominal Size	D	
m	6	0.50 - 1.00	071355
	6	1.00 - 1.50	071356
	6	1.50 - 2.00	071357
	6	2.00 - 2.50	071358
	6	2.50 - 3.00	071359
	6	3.00 - 3.50	071360
	6	3.50 - 4.00	071361
	6	4.00 - 4.50	071362
	6	4.50 - 5.00	071363
	6	5.00 - 5.50	071364
	6	5.50 - 6.00	071365
	10	0.50 - 1.00	071368
	10	1.00 - 1.50	071369
	10	1.50 - 2.00	071370
	10	2.00 - 2.50	071371
	10	2.50 - 3.00	071372
	10	3.00 - 3.50	071373
	10	3.50 - 4.00	071374
	10	4.00 - 4.50	071375
	10	4.50 - 5.00	071376
10	5.00 - 5.50	071377	
10	5.50 - 6.00	071378	
10	6.00 - 6.50	071379	
10	6.50 - 7.00	071380	
10	7.00 - 7.50	071381	
10	7.50 - 8.00	071382	
10	8.00 - 8.50	071383	
10	8.50 - 9.00	071384	
10	9.00 - 9.50	071385	
10	9.50 - 10.00	071681	

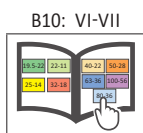
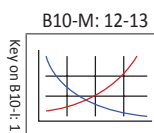

m = Metric (mm)

Accessories for Collet Chucks

ISO 10897-A (DIN 6388-A)

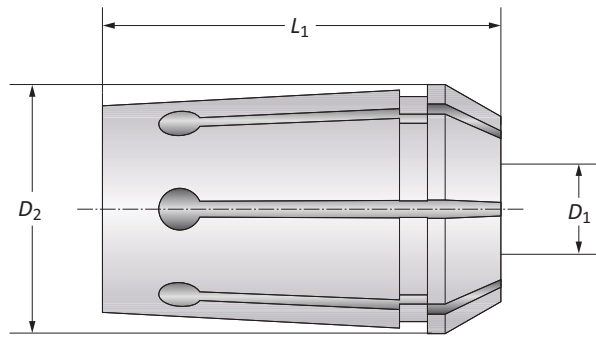

Collet Sets

	Nominal Size	Standard-No.	Set			Part No.
			D_2	L_1	D_1	
m	A 16	410 E	22.65	40.00	2.00 - 16.00	071003
	A 25	444 E	32.90	52.00	2.00 - 25.00	071004
	A 32	450 E	41.30	60.00	4.00 - 32.00	071019

Collets

	Nominal Size	Diameter	
		D_1	Part No.
m	A 16	2.00	071140
	A 16	2.50	071141
	A 16	3.00	071142
	A 16	3.50	071143
	A 16	4.00	071144
	A 16	4.50	071145
	A 16	5.00	071146
	A 16	5.50	071147
	A 16	6.00	071148
	A 16	6.50	071149
	A 16	7.00	071150
	A 16	7.50	071151
	A 16	8.00	071152
	A 16	8.50	071153
	A 16	9.00	071154
	A 16	9.50	071155
	A 16	10.00	071156
	A 16	10.50	071157
	A 16	11.00	071158
	A 16	11.50	071159
	A 16	12.00	071160
	A 16	12.50	071161
	A 16	13.00	071162
	A 16	13.50	071163
	A 16	14.00	071164
	A 16	14.50	071165
	A 16	15.00	071166
	A 16	15.50	071167
A 16	16.00	071168	

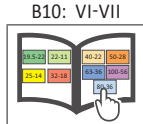
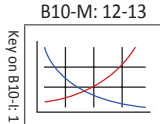

m = Metric (mm)

Accessories for Collet Chucks

ISO 10897-A (DIN 6388-A)

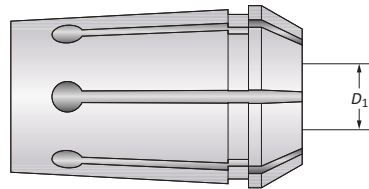

Collets

	Nominal Size	Diameter	
		D_1	Part No.
	A 25	2.00	071169
	A 25	3.00	071170
	A 25	4.00	071171
	A 25	5.00	071172
	A 25	6.00	071173
	A 25	7.00	071174
	A 25	8.00	071175
	A 25	9.00	071176
	A 25	10.00	071177
	A 25	11.00	071178
	A 25	12.00	071179
	A 25	13.00	071180
	A 25	14.00	071181
	A 25	15.00	071182
	A 25	16.00	071183
	A 25	17.00	071184
	A 25	18.00	071185
	A 25	19.00	071186
	A 25	20.00	071187
	A 25	21.00	071188
	A 25	22.00	071189
	A 25	23.00	071190
	A 25	24.00	071191
	A 25	25.00	071192
	A 32	4.00	071612
	A 32	5.00	071419
III	A 32	6.00	071420
	A 32	7.00	071613
	A 32	8.00	071421
	A 32	9.00	071614
	A 32	10.00	071422
	A 32	11.00	071666
	A 32	12.00	071423
	A 32	13.00	071667
	A 32	14.00	071668
	A 32	15.00	071669
	A 32	16.00	071424
	A 32	17.00	071670
	A 32	18.00	071665
	A 32	19.00	071671
	A 32	20.00	071416
	A 32	21.00	071672
	A 32	22.00	071673
	A 32	23.00	071674
	A 32	24.00	071675
	A 32	25.00	071417
	A 32	26.00	071676
	A 32	27.00	071677
	A 32	28.00	071678
	A 32	29.00	071679
	A 32	30.00	071633
	A 32	31.00	071680
	A 32	32.00	071418

Accessories for Collet Chucks

ISO 10897-B (DIN 6388-B)

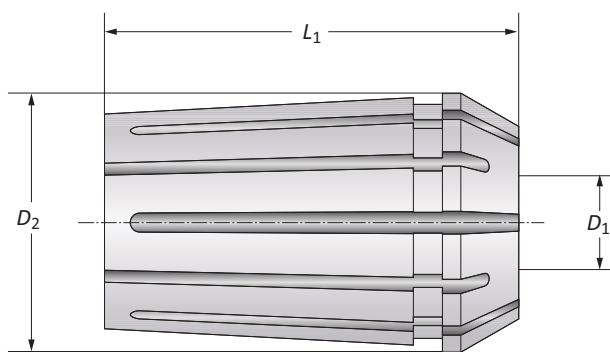

Collet Sets

	Nominal Size	Standard-No.	Set			Part No.
			D_2	L_1	D_1	
m	B 16	415 E	22.65	40.00	1.50 - 16.00	071005
	B 25	462 E	32.90	52.00	3.50 - 25.00	071006
	B 32	467 E	41.30	60.00	5.50 - 32.00	071022

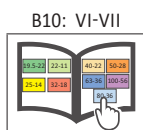
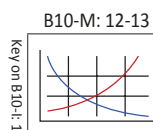

m = Metric (mm)

Accessories for Collet Chucks

ISO 10897-B (DIN 6388-B)

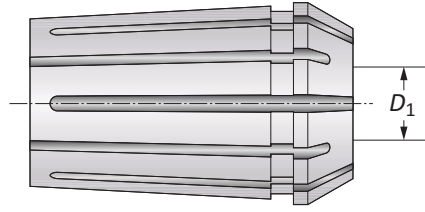

Collets

Nominal Size	Diameter D_1	Part No.
B 25	3.50 - 4.00	071627
B 25	4.00 - 4.50	071628
B 25	4.50 - 5.00	071218
B 25	5.00 - 5.50	071219
B 25	5.50 - 6.00	071220
B 25	6.00 - 6.50	071221
B 25	6.50 - 7.00	071222
B 25	7.00 - 7.50	071223
B 25	7.50 - 8.00	071224
B 25	8.00 - 8.50	071225
B 25	8.50 - 9.00	071226
B 25	9.00 - 9.50	071227
B 25	9.50 - 10.00	071228
B 25	10.00 - 10.50	071229
B 25	10.50 - 11.00	071230
B 25	11.00 - 11.50	071231
B 25	11.50 - 12.00	071232
B 25	12.00 - 12.50	071233
B 25	12.50 - 13.00	071234
B 25	13.00 - 13.50	071235
B 25	13.50 - 14.00	071236
B 25	14.00 - 14.50	071237
B 25	14.50 - 15.00	071238
B 25	15.00 - 15.50	071239
B 25	15.50 - 16.00	071240
B 25	16.00 - 16.50	071241
B 25	16.50 - 17.00	071242
B 25	17.00 - 17.50	071243
B 25	17.50 - 18.00	071244
B 25	18.00 - 18.50	071245
B 25	18.50 - 19.00	071246
B 25	19.00 - 19.50	071247
B 25	19.50 - 20.00	071248
B 25	20.00 - 20.50	071249
B 25	20.50 - 21.00	071250
B 25	21.00 - 21.50	071251
B 25	21.50 - 22.00	071252
B 25	22.00 - 22.50	071253
B 25	22.50 - 23.00	071254
B 25	23.00 - 23.50	071255
B 25	23.50 - 24.00	071256
B 25	24.00 - 24.50	071257
B 25	24.50 - 25.00	071258

m

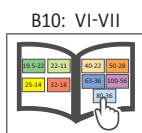
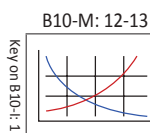

m = Metric (mm)

Accessories for Collet Chucks

ISO 10897-B (DIN 6388-B)

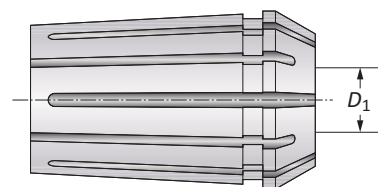

Collets

Nominal Size	Diameter	Part No.
	D_1	
B 32	5.50 - 6.00	071686
B 32	6.00 - 6.50	071687
B 32	6.50 - 7.00	071688
B 32	7.00 - 7.50	071689
B 32	7.50 - 8.00	071690
B 32	8.00 - 8.50	071691
B 32	8.50 - 9.00	071692
B 32	9.00 - 9.50	071693
B 32	9.50 - 10.00	071542
B 32	10.00 - 10.50	071543
B 32	10.50 - 11.00	071544
B 32	11.00 - 11.50	071545
B 32	11.50 - 12.00	071546
B 32	12.00 - 12.50	071547
B 32	12.50 - 13.00	071548
B 32	13.00 - 13.50	071549
B 32	13.50 - 14.00	071550
B 32	14.00 - 14.50	071551
B 32	14.50 - 15.00	071552
B 32	15.00 - 15.50	071553
B 32	15.50 - 16.00	071554
B 32	16.00 - 16.50	071555
B 32	16.50 - 17.00	071556
B 32	17.00 - 17.50	071557
B 32	17.50 - 18.00	071558
B 32	18.00 - 18.50	071559
B 32	18.50 - 19.00	071560
B 32	19.00 - 19.50	071561
B 32	19.50 - 20.00	071562
B 32	20.00 - 20.50	071563
B 32	20.50 - 21.00	071564
B 32	21.00 - 21.50	071565
B 32	21.50 - 22.00	071566
B 32	22.00 - 22.50	071567
B 32	22.50 - 23.00	071568
B 32	23.00 - 23.50	071569
B 32	23.50 - 24.00	071570
B 32	24.00 - 24.50	071571
B 32	24.50 - 25.00	071572
B 32	25.00 - 25.50	071573
B 32	25.50 - 26.00	071574
B 32	26.00 - 26.50	071575
B 32	26.50 - 27.00	071576
B 32	27.00 - 27.50	071577
B 32	27.50 - 28.00	071578
B 32	28.00 - 28.50	071579
B 32	28.50 - 29.00	071580
B 32	29.00 - 29.50	071581
B 32	29.50 - 30.00	071582
B 32	30.00 - 30.50	071583
B 32	30.50 - 31.00	071584
B 32	31.00 - 31.50	071585
B 32	31.50 - 32.00	071586

m

Accessories for Collet Chucks

ISO 10897-A (DIN 6388-A)

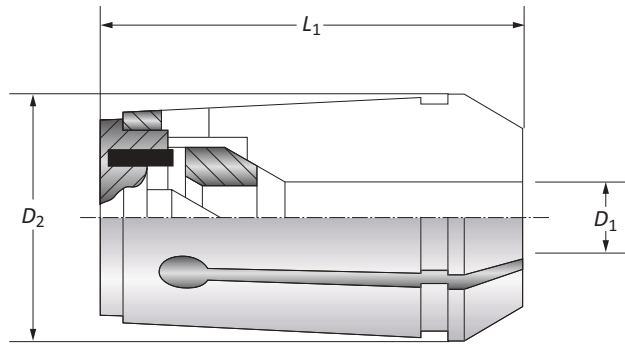

Collet Sets for Clarkson System

	Nominal Size	Standard-No.	Diameter		Part No.
			D_1	D_2	
m	A 16	421 E	6.00 - 12.00	22.65	071013
	A 25	459 E	6.00 - 25.00	32.90	071014
	A 32	460 E	6.00 - 32.00	41.30	071020

NOTE: Recommended to use clamping nuts with ball bearings to lock collets.

Collets for Clarkson System

	Nominal Size	Diameter	
		D_1	Part No.
m	A 16	6.00	071304
	A 16	8.00	071305
	A 16	10.00	071306
	A 16	12.00	071307
	A 25	6.00	071308
	A 25	8.00	071309
	A 25	10.00	071310
	A 25	12.00	071311
	A 25	16.00	071312
	A 25	20.00	071313
	A 25	25.00	071684
	A 32	6.00	071427
	A 32	8.00	071428
	A 32	10.00	071429
	A 32	12.00	071430
	A 32	16.00	071431
	A 32	20.00	071432
	A 32	25.00	071433
	A 32	32.00	071685

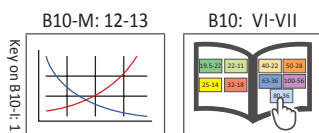

Accessories for Collet Chucks

ISO 15488-B (DIN 6499-B)

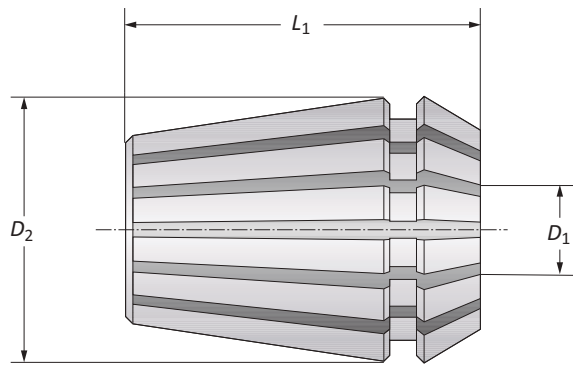

Collet Sets

	Nominal Size	Standard-No.	Diameter		Collet Set	Part No.
			D_1	D_2		
m	ER 8	4004 E	1.00 - 5.00	8.50	13.50	071034
	ER 11	4008 E	1.00 - 7.00	11.00	18.00	071028
	ER 16	426 E	0.50 - 10.00	16.00	27.50	071029
	ER 25	430 E	1.50 - 16.00	25.00	34.00	071031
	ER 32	470 E	2.00 - 20.00	32.00	40.00	071032
	ER 40	472 E	3.00 - 26.00	40.00	46.00	071033

Collets

	Nominal Size	Diameter		Part No.
		D_1	D_2	
m	ER 8	1.00		071986
	ER 8	1.50		071987
	ER 8	2.00		071988
	ER 8	2.50		071989
	ER 8	2.60 - 3.00		071990
	ER 8	3.10 - 3.50		071991
	ER 8	3.60 - 4.00		071992
	ER 8	4.10 - 4.50		071993
	ER 8	4.60 - 5.00		071994
	ER 11	1.00		071700
	ER 11	1.50		071701
	ER 11	2.00		071702
	ER 11	2.50		071703
	ER 11	2.60 - 3.00		071704
	ER 11	3.10 - 3.50		071705
	ER 11	3.60 - 4.00		071706
	ER 11	4.10 - 4.50		071707
	ER 11	4.60 - 5.00		071708
	ER 11	5.10 - 5.50		071709
	ER 11	5.60 - 6.00		071710
	ER 11	6.10 - 6.50		071711
	ER 11	6.60 - 7.00		071712

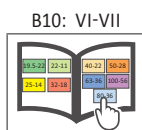
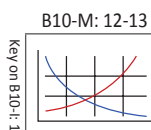

m = Metric (mm)

Accessories for Collet Chucks

ISO 15488-B (DIN 6499-B)

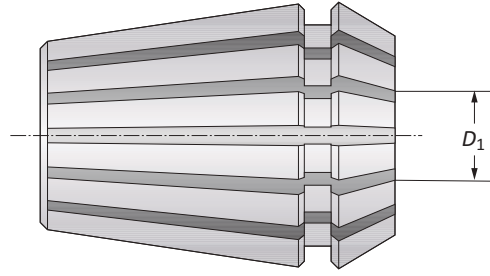

Collets

	Nominal Size	Diameter	
			D_1
	ER 16	0.50 - 1.00	071713
	ER 16	1.00 - 1.50	071714*
	ER 16	1.00 - 2.00	071715
	ER 16	2.00 - 2.50	071716*
	ER 16	2.50 - 3.00	071717
	ER 16	3.00 - 3.50	071718*
	ER 16	3.50 - 4.00	071719
	ER 16	4.00 - 4.50	271132*
	ER 16	4.00 - 5.00	071720
m	ER 16	5.00 - 5.50	271133*
	ER 16	5.50 - 6.00	071721
	ER 16	6.00 - 6.50	271134*
	ER 16	6.00 - 7.00	071722
	ER 16	7.00 - 7.50	271135*
	ER 16	7.50 - 8.00	071723
	ER 16	8.00 - 8.50	271136*
	ER 16	8.50 - 9.00	071724
	ER 16	9.00 - 9.50	271137*
	ER 16	9.00 - 10.00	071725

* Items not contained in set.

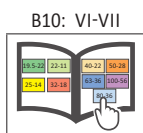
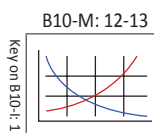





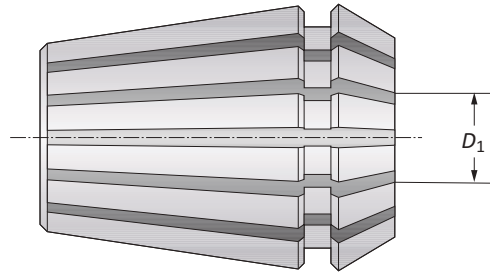















Accessories for Collet Chucks

ISO 15488-B (DIN 6499-B)



Collets

Nominal Size	Diameter		Part No.
	D_1		
ER 25	1.50 - 2.00		071743
ER 25	2.00 - 2.50		071744*
ER 25	2.50 - 3.00		071745
ER 25	3.00 - 3.50		271128*
ER 25	3.50 - 4.00		071746
ER 25	4.00 - 4.50		271129*
ER 25	4.50 - 5.00		071747
ER 25	5.00 - 5.50		271130*
ER 25	5.50 - 6.00		071748
ER 25	6.00 - 6.50		271131*
ER 25	6.50 - 7.00		071749
ER 25	7.00 - 8.00		071750
ER 25	8.00 - 9.00		071751
ER 25	9.00 - 10.00		071752
ER 25	10.00 - 11.00		071753
ER 25	11.00 - 12.00		071754
ER 25	12.00 - 13.00		071755
ER 25	13.00 - 14.00		071756
ER 25	14.00 - 15.00		071757
ER 25	15.00 - 16.00		071758
 ER 32	2.00 - 3.00		071761
 ER 32	3.00 - 4.00		071762
 ER 32	4.00 - 5.00		071763
 ER 32	5.00 - 6.00		071764
 ER 32	6.00 - 7.00		071765
 ER 32	7.00 - 8.00		071766
 ER 32	8.00 - 9.00		071767
 ER 32	9.00 - 10.00		071768
 ER 32	10.00 - 11.00		071769
 ER 32	11.00 - 12.00		071770
 ER 32	12.00 - 13.00		071771
 ER 32	13.00 - 14.00		071772
 ER 32	14.00 - 15.00		071773
 ER 32	15.00 - 16.00		071774
 ER 32	16.00 - 17.00		071775
 ER 32	17.00 - 18.00		071776
 ER 32	18.00 - 19.00		071777
 ER 32	19.00 - 20.00		071778
 ER 32	17.00 - 18.00		071776
 ER 32	18.00 - 19.00		071777
 ER 32	19.00 - 20.00		071778

* Items not contained in set.

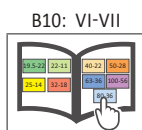
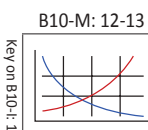

 = Metric (mm)

Accessories for Collet Chucks

ISO 15488-B (DIN 6499-B)

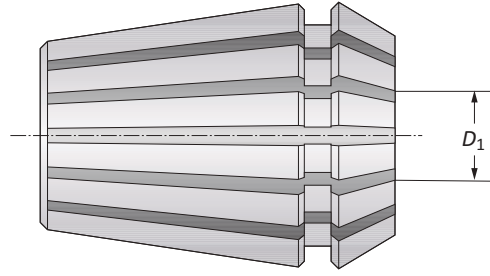

	Nominal Size	Diameter		Part No.
		D_1		
	ER 40	3.00 - 4.00		071779
	ER 40	4.00 - 5.00		071780
	ER 40	5.00 - 6.00		071781
	ER 40	6.00 - 7.00		071782
	ER 40	7.00 - 8.00		071783
	ER 40	8.00 - 9.00		071784
	ER 40	9.00 - 10.00		071785
	ER 40	10.00 - 11.00		071786
	ER 40	11.00 - 12.00		071787
	ER 40	12.00 - 13.00		071788
m	ER 40	13.00 - 14.00		071789
	ER 40	14.00 - 15.00		071790
	ER 40	15.00 - 16.00		071791
	ER 40	16.00 - 17.00		071792
	ER 40	17.00 - 18.00		071793
	ER 40	18.00 - 19.00		071794
	ER 40	19.00 - 20.00		071795
	ER 40	20.00 - 21.00		071796
	ER 40	21.00 - 22.00		071797
	ER 40	22.00 - 23.00		071798
	ER 40	23.00 - 24.00		071799
	ER 40	24.00 - 25.00		071800
	ER 40	25.00 - 26.00		071801

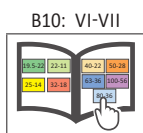
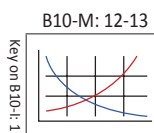

Collet Sets for Taps DIN 371/374/376

ISO 15488-B (DIN 6499-B)

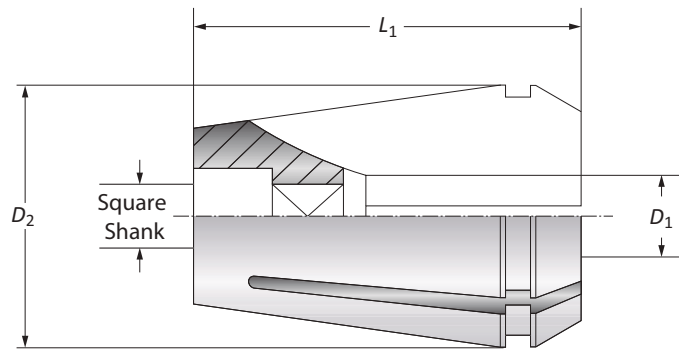

Collet Sets

	Nominal Size	Standard-No.	Clamping Range	Collet Set		Part No.
				D_1	D_2	
m	ER 16	426 EGB	4.50 - 7.00	16.00	27.50	071045
	ER 25	430 EGB	4.50 - 12.00	25.00	34.00	071047
	ER 32	470 EGB	4.50 - 16.00	32.00	40.00	071048
	ER 40	472 EGB	7.00 - 20.00	40.00	46.00	071049

NOTE: To lock these collets, we recommend using the clamping nuts with sliding ring for higher clamping forces.

Taps

	Shank		Tap		
	D_1	Square Shank	DIN 371	DIN 374	DIN 376
m	4.50	3.40	M 4	M 6 x...	M 6
	5.50	4.30	-	M 7 x...	M 7
	6.00	4.90	M 4,5/5/6	M 8 x...	M 8
	7.00	5.50	M 7	M 9/10 x...	M 9/10
	8.00	6.20	M 8	M 6 x...	M 11
	9.00	7.00	M 9	M 6 x...	M 12
	10.00	8.00	M 10	-	-
	11.00	9.00	-	M 14 x...	M 14
	12.00	9.00	M 12	M 16 x...	M 16
	14.00	11.00	-	M 18 x...	M 18
	16.00	12.00	-	M 20 x...	M 20
	18.00	14.00	-	M 22/24 x...	M 22/24
	20.00	16.00	-	M 27 x...	M 27

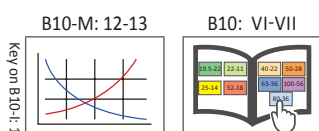

m = Metric (mm)

Accessories for Collet Sets for Taps DIN 371/374/376

ISO 15488-B (DIN 6499-B)

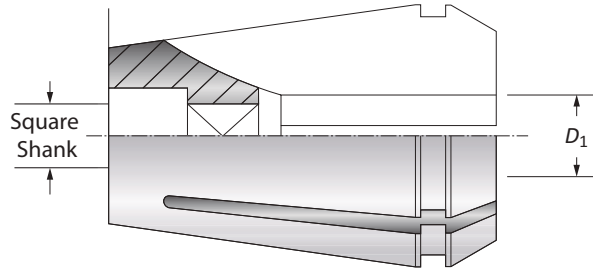

Nominal Size	Suitable Taps		Part No.
	D_1	Square Shank	
ER 16	4.50	3.40	071901
ER 16	5.50	4.30	071902
ER 16	6.00	4.90	071903
ER 16	7.00	5.50	071904
ER 25	4.50	3.40	071912
ER 25	5.50	4.30	071913
ER 25	6.00	4.90	071914
ER 25	7.00	5.50	071915
ER 25	8.00	6.20	071916
ER 25	9.00	7.00	071917
ER 25	10.00	8.00	071918
ER 25	11.00	9.00	071919
ER 25	12.00	9.00	071920
ER 32	4.50	3.40	071921
ER 32	5.50	4.30	071922
ER 32	6.00	4.90	071923
ER 32	7.00	5.50	071924
ER 32	8.00	6.20	071925
ER 32	9.00	7.00	071926
ER 32	10.00	8.00	071927
ER 32	11.00	9.00	071928
ER 32	12.00	9.00	071929
ER 32	14.00	11.00	071930
ER 32	16.00	12.00	071931
ER 40	7.00	5.50	071932
ER 40	8.00	6.20	071933
ER 40	9.00	7.00	071934
ER 40	10.00	8.00	071935
ER 40	11.00	9.00	071936
ER 40	12.00	9.00	071937
ER 40	14.00	11.00	071938
ER 40	16.00	12.00	071939
ER 40	18.00	14.50	071940
ER 40	20.00	16.00	071941

Ⓜ

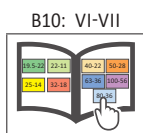
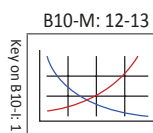

Accessories for Collet Chucks: ISO 15488-B (DIN 6499-B)

Collets

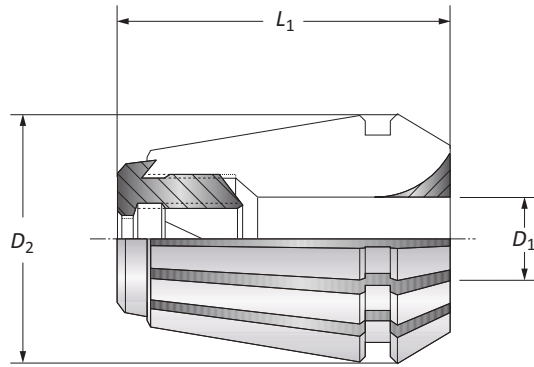

Collets for Mill Cutters with Pull Thread System

	Nominal Size	Standard-No.	Clamping Range D_2	Collet		Part No.
				L_1	D_1	
m	ER 32	470 ECL	32.00	46.00	6.00 - 16.00	071052
	ER 40	472 ECL	40.00	52.00	6.00 - 25.00	071053

Collets

	Collet		Part No.
	Nominal Size	D_1	
m	ER 32	6.00	071826
	ER 32	8.00	071827
	ER 32	10.00	071828
	ER 32	12.00	071829
	ER 32	16.00	071830
	ER 40	6.00	071831
	ER 40	8.00	071832
	ER 40	10.00	071833
	ER 40	12.00	071834
	ER 40	16.00	071835
	ER 40	20.00	071836
	ER 40	25.00	071837

NOTE: To lock these collets, we recommend using the clamping nuts with sliding ring for higher clamping forces.

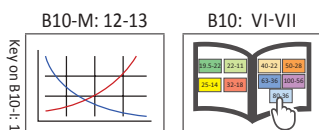

m = Metric (mm)

Accessories for Collet Chucks: ISO 10897 (DIN 6388)

A
B
C
D
E
F
G
H
I
J
K
L
M
INDEX

Clamping Nuts

Clamping Nuts: DIN 6388 / ISO 10897 - 1:10

	Nominal Size	Clamping Nut				Part No.
		D_1	L_1	Clamping Range	Torque	
m	16	43.00	24.00	2.00 - 16.00	100 Nm	068048
	25	60.00	30.00	2.00 - 25.00	180 Nm	068052
	32	72.00	33.50	4.00 - 32.00	220 Nm	161099

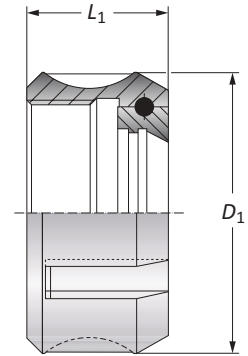

Clamping Nuts for Sealing Discs: DIN 6388 / ISO 10897 - 1:10

	Nominal Size	Clamping Nut				Part No.
		D_1	L_1	Clamping Range	Torque	
m	16	43.00	31.50	2.00 - 16.00	100 Nm	275001
	25	60.00	38.00	2.00 - 25.00	180 Nm	275003
	32	72.00	42.00	4.00 - 32.00	220 Nm	276001

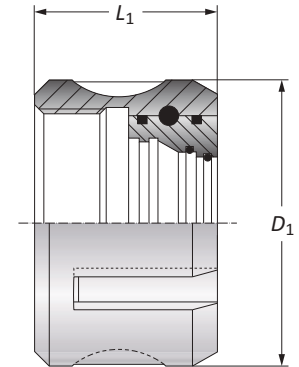

NOTE: With ball bearing, for use with sealing discs.

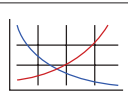
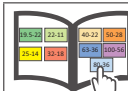
B10-M: 12-13  B10: VI-VII 

Key on B10-I: 1

Accessories for Collet Chucks: ISO 10897 (DIN 6388)

Clamping Nuts

Mini Clamping Nuts

	Nominal Size	Clamping Nut			Torque	Part No.
		D_1	L_1	Clamping Range		
	ER 08	12.00	10.80	1.00 - 4.00	8 Nm	415357
	ER 11	16.00	12.00	1.00 - 7.00	16 Nm	415358
	ER 16	22.00	18.00	1.00 - 10.00	25 Nm	415359

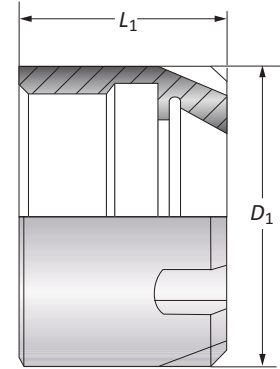

Clamping Nuts for Erickson Collet Chuck System

	Nominal Size	Clamping Nut			Part No.
		D_1	L_1	Clamping Range	
	6	14.00	28.00	1.00 - 6.50	162095
	10	21.00	36.00	1.00 - 10.00	162093

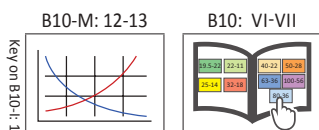
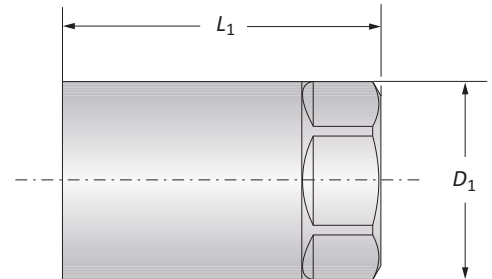

 = Metric (mm)

Accessories for Collet Chucks: ISO 15488 (DIN 6499)

Clamping Nuts

One Piece Clamping Nuts: DIN 6499 / ISO 15488 - 8°

		Clamping Nut				
Nominal Size	D_1	L_1	Clamping Range	Torque	Part No.	
m	ER 16	28.00	17.50	1.00 - 10.00	60 Nm	215922
	ER 25	42.00	20.00	2.00 - 16.00	100 Nm	215924
	ER 32	50.00	22.50	2.00 - 20.00	140 Nm	215925
	ER 40	63.00	25.50	3.00 - 26.00	180 Nm	215926

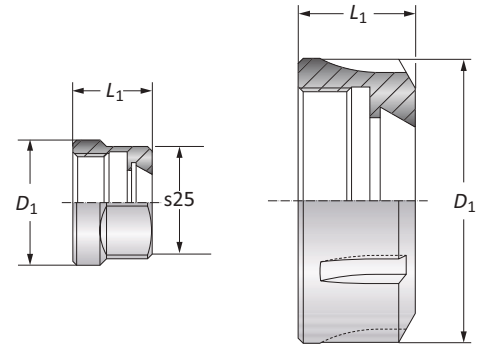

Clamping Nuts with Sliding Ring: DIN 6499 / ISO 15488 - 8°

		Clamping Nut				
Nominal Size	D_1	L_1	Clamping Range	Torque	Part No.	
m	ER 16	28.00	20.30	1.00 - 10.00	60 Nm	315015
	ER 25	42.00	22.40	2.00 - 16.00	100 Nm	315016
	ER 32	50.00	25.00	2.00 - 20.00	140 Nm	315017
	ER 40	63.00	28.30	3.00 - 26.00	180 Nm	315018

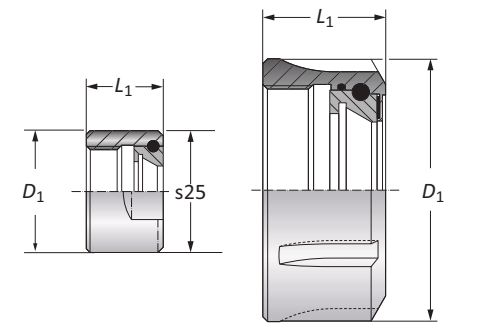

One Piece Clamping Nuts for use with Sealing Disks: DIN 6499 / ISO 15488 - 8°

		Clamping Nut				
Nominal Size	D_1	L_1	Clamping Range	Torque	Part No.	
m	ER 16	28.00	25.00	1.00 - 10.00	60 Nm	277001
	ER 25	42.00	27.50	2.00 - 16.00	100 Nm	277005
	ER 32	50.00	30.50	2.00 - 20.00	140 Nm	277007
	ER 40	63.00	34.00	3.00 - 26.00	180 Nm	278001

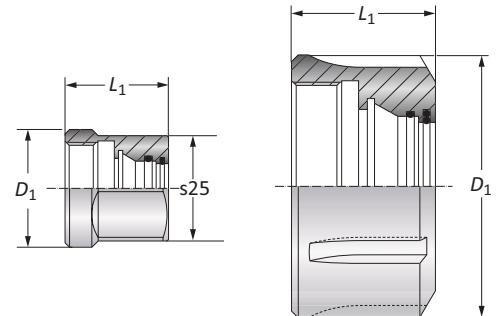

Clamping Nuts with Sliding Ring for use with Sealing Disks: DIN 6499 / ISO 15488 - 8°

		Clamping Nuts: ISO 15488 (DIN 6499)				
Nominal Size	D_1	L_1	Clamping Range	Torque	Part No.	
m	ER 16	28.00	25.00	1.00 - 10.00	60 Nm	277002
	ER 25	42.00	28.50	2.00 - 16.00	100 Nm	277006
	ER 32	50.00	31.50	2.00 - 20.00	140 Nm	277008
	ER 40	63.00	35.00	3.00 - 26.00	180 Nm	278002

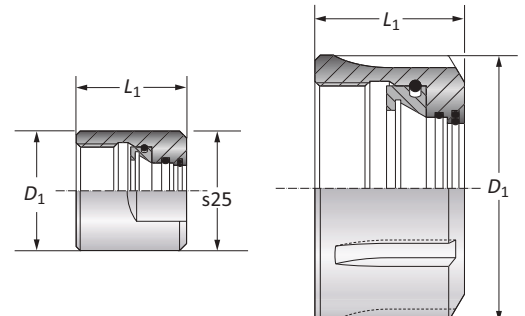

B10-M: 12-13

B10: VI-VII

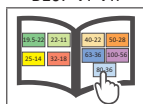
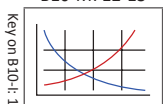

m = Metric (mm)

Sealing Disks for Collet Chucks: ISO 10897 (DIN 6388)

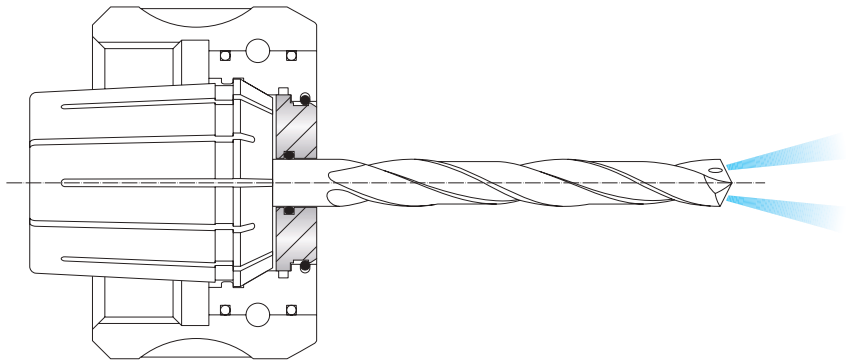

Nominal Size	Sealing Disk		Sealing Disk		Sealing Disk		Sealing Disk	
	Diameter	Part No.	Diameter	Part No.	Diameter	Part No.	Diameter	Part No.
16	2.50 - 3.00	275010	6.00 - 6.50	275017	9.50 - 10.00	275024	13.00 - 13.50	275031
16	3.00 - 3.50	275011	6.50 - 7.00	275018	10.00 - 10.50	275025	13.50 - 14.00	275032
16	3.50 - 4.00	275012	7.00 - 7.50	275019	10.50 - 11.00	275026	14.00 - 14.50	275033
16	4.00 - 4.50	275013	7.50 - 8.00	275020	11.00 - 11.50	275027	14.50 - 15.00	275034
16	4.50 - 5.00	275014	8.00 - 8.50	275021	11.50 - 12.00	275028	15.00 - 15.50	275035
16	5.00 - 5.50	275015	8.50 - 9.00	275022	12.00 - 12.50	275029	15.50 - 16.00	275036
16	5.50 - 6.00	275016	9.00 - 9.50	275023	12.50 - 13.00	275030	–	–
25	2.50 - 3.00	275040	8.50 - 9.00	275052	14.50 - 15.00	275064	20.50 - 21.00	275076
25	3.00 - 3.50	275041	9.00 - 9.50	275053	15.00 - 15.50	275065	21.00 - 21.50	275077
25	3.50 - 4.00	275042	9.50 - 10.00	275054	15.50 - 16.00	275066	21.50 - 22.00	275078
25	4.00 - 4.50	275043	10.00 - 10.50	275055	16.00 - 16.50	275067	22.00 - 22.50	275079
25	4.50 - 5.00	275044	10.50 - 11.00	275056	16.50 - 17.00	275068	22.50 - 23.00	275080
25	5.00 - 5.50	275045	11.00 - 11.50	275057	17.00 - 17.50	275069	23.00 - 23.50	275081
25	5.50 - 6.00	275046	11.50 - 12.00	275058	17.50 - 18.00	275070	23.50 - 24.00	275082
25	6.00 - 6.50	275047	12.00 - 12.50	275059	18.00 - 18.50	275071	24.00 - 24.50	275083
25	6.50 - 7.00	275048	12.50 - 13.00	275060	18.50 - 19.00	275072	24.50 - 25.00	275084
25	7.00 - 7.50	275049	13.00 - 13.50	275061	19.00 - 19.50	275073	–	–
25	7.50 - 8.00	275050	13.50 - 14.00	275062	19.50 - 20.00	275074	–	–
25	8.00 - 8.50	275051	14.00 - 14.50	275063	20.00 - 20.50	275075	–	–
32	3.50 - 4.00	276005	11.00 - 11.50	276020	18.50 - 19.00	276035	26.00 - 26.50	276050
32	4.00 - 4.50	276006	11.50 - 12.00	276021	19.00 - 19.50	276036	26.50 - 27.00	276051
32	4.50 - 5.00	276007	12.00 - 12.50	276022	19.50 - 20.00	276037	27.50 - 28.00	276052
32	5.00 - 5.50	276008	12.50 - 13.00	276023	20.00 - 20.50	276038	27.50 - 28.00	276053
32	5.50 - 6.00	276009	13.00 - 13.50	276024	20.50 - 21.00	276039	28.00 - 28.50	276054
32	6.00 - 6.50	276010	13.50 - 14.00	276025	21.00 - 21.50	276040	28.50 - 29.00	276055
32	6.50 - 7.00	276011	14.00 - 14.50	276026	21.50 - 22.00	276041	29.00 - 29.50	276056
32	7.00 - 7.50	276012	14.50 - 15.00	276027	22.00 - 22.50	276042	29.50 - 30.00	276057
32	7.50 - 8.00	276013	15.00 - 15.50	276028	22.50 - 23.00	276043	30.00 - 30.50	276058
32	8.00 - 8.50	276014	15.50 - 16.00	276029	23.00 - 23.50	276044	30.50 - 31.00	276059
32	8.50 - 9.00	276015	16.00 - 16.50	276030	23.50 - 24.00	276045	31.00 - 31.50	276060
32	9.00 - 9.50	276016	16.50 - 17.00	276031	24.00 - 24.50	276046	31.50 - 32.00	276061
32	9.50 - 10.00	276017	17.00 - 17.50	276032	24.50 - 25.00	276047	–	–
32	10.00 - 10.50	276018	17.50 - 18.00	276033	25.00 - 25.50	276048	–	–
32	10.50 - 11.00	276019	18.00 - 18.50	276034	25.50 - 26.00	276049	–	–

mm

B10-M: 12-13

B10: VI-VII

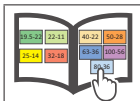
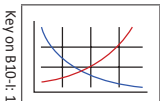

mm = Metric (mm)

Sealing Disks Collet Chucks: ISO 15488 (DIN 6499)

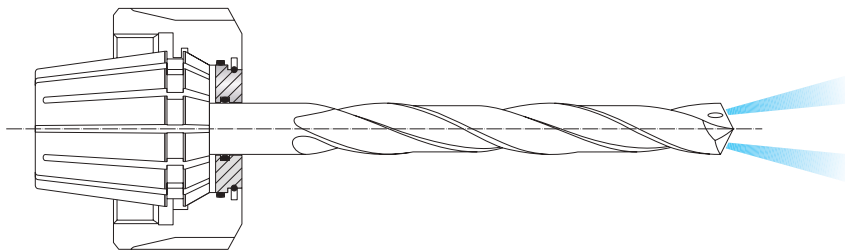

Nominal Size	Sealing Disk		Sealing Disk		Sealing Disk		Sealing Disk	
	Diameter	Part No.	Diameter	Part No.	Diameter	Part No.	Diameter	Part No.
ER 16	2.50 - 3.00	277010	4.50 - 5.00	277014	6.50 - 7.00	277018	8.50 - 9.00	277022
ER 16	3.00 - 3.50	277011	5.00 - 5.50	277015	7.00 - 7.50	277019	9.00 - 9.50	277023
ER 16	3.50 - 4.00	277012	5.50 - 6.00	277016	7.50 - 8.00	277020	9.50 - 10.00	277024
ER 16	4.00 - 4.50	277013	6.00 - 6.50	277017	8.00 - 8.50	277021	–	–
ER 25	2.50 - 3.00	277025	6.00 - 6.50	277032	9.50 - 10.00	277039	13.00 - 13.50	277046
ER 25	3.00 - 3.50	277026	6.50 - 7.00	277033	10.00 - 10.50	277040	13.50 - 14.00	277047
ER 25	3.50 - 4.00	277027	7.00 - 7.50	277034	10.50 - 11.00	277041	14.00 - 14.50	277048
ER 25	4.00 - 4.50	277028	7.50 - 8.00	277035	11.00 - 11.50	277042	14.50 - 15.00	277049
ER 25	4.50 - 5.00	277029	8.00 - 8.50	277036	11.50 - 12.00	277043	15.00 - 15.50	277050
ER 25	5.00 - 5.50	277030	8.50 - 9.00	277037	12.00 - 12.50	277044	15.50 - 16.00	277051
ER 25	5.50 - 6.00	277031	9.00 - 9.50	277038	12.50 - 13.00	277045	–	–
ER 32	2.50 - 3.00	277055	7.00 - 7.50	277064	11.50 - 12.00	277073	16.00 - 16.50	277082
ER 32	3.00 - 3.50	277056	7.50 - 8.00	277065	12.00 - 12.50	277074	16.50 - 17.00	277083
ER 32	3.50 - 4.00	277057	8.00 - 8.50	277066	12.50 - 13.00	277075	17.00 - 17.50	277084
ER 32	4.00 - 4.50	277058	8.50 - 9.00	277067	13.00 - 13.50	277076	17.50 - 18.00	277085
ER 32	4.50 - 5.00	277059	9.00 - 9.50	277068	13.50 - 14.00	277077	18.00 - 18.50	277086
ER 32	5.00 - 5.50	277060	9.50 - 10.00	277069	14.00 - 14.50	277078	18.50 - 19.00	277087
ER 32	5.50 - 6.00	277061	10.00 - 10.50	277070	14.50 - 15.00	277079	19.00 - 19.50	277088
ER 32	6.00 - 6.50	277062	10.50 - 11.00	277071	15.00 - 15.50	277080	19.50 - 20.00	277089
ER 32	6.50 - 7.00	277063	11.00 - 11.50	277072	15.50 - 16.00	277081	–	–
ER 40	2.50 - 3.00	278005	8.50 - 9.00	278017	14.50 - 15.00	278029	20.50 - 21.00	278041
ER 40	3.00 - 3.50	278006	9.00 - 9.50	278018	15.00 - 15.50	278030	21.00 - 21.50	278042
ER 40	3.50 - 4.00	278007	9.50 - 10.00	278019	15.50 - 16.00	278031	21.50 - 22.00	278043
ER 40	4.00 - 4.50	278008	10.00 - 10.50	278020	16.00 - 16.50	278032	22.00 - 22.50	278044
ER 40	4.50 - 5.00	278009	10.50 - 11.00	278021	16.50 - 17.00	278033	22.50 - 23.00	278045
ER 40	5.00 - 5.50	278010	11.00 - 11.50	278022	17.00 - 17.50	278034	23.00 - 23.50	278046
ER 40	5.50 - 6.00	278011	11.50 - 12.00	278023	17.50 - 18.00	278035	23.50 - 24.00	278047
ER 40	6.00 - 6.50	278012	12.00 - 12.50	278024	18.00 - 18.50	278036	24.00 - 24.50	278048
ER 40	6.50 - 7.00	278013	12.50 - 13.00	278025	18.50 - 19.00	278037	24.50 - 25.00	278049
ER 40	7.00 - 7.50	278014	13.00 - 13.50	278026	19.00 - 19.50	278038	25.00 - 25.50	278050
ER 40	7.50 - 8.00	278015	13.50 - 14.00	278027	19.50 - 20.00	278039	25.50 - 26.00	278051
ER 40	8.00 - 8.50	278016	14.00 - 14.50	278028	20.00 - 20.50	278040	–	–

m

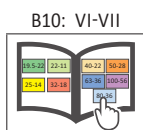
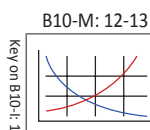

m = Metric (mm)

Accessories for Milling Machine Arbors

Accessories for Milling Machine Arbors

Shell-Mill Adapter	Part No.		
	1 Clutch Drive Ring	2 Axial Drive Key	3 Retaining Screw
13	115708	115709	115707
16	115696	215608	115697
22	115341	215609	115345
27	115342	215610	115346
32	115343	215611	115347
40	115344	215612	115348

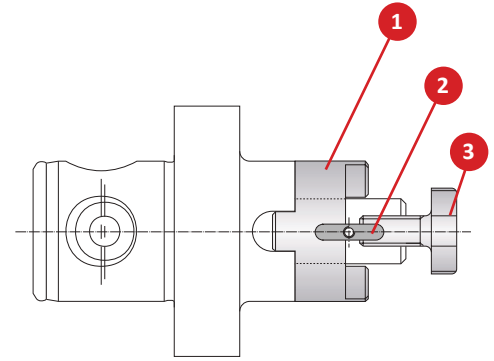

Accessories for Milling Machine Arbors

Shell-Mill Adapter	Part No.		
	1 Drive Key	2 Cap Screw	3 Retaining Screw
16	215701	115566	115697
22	215702	108109	115345
27	215703	108109	115346
32	215704	115147	115347
40	215705	116152	115348
60	115643	115237	-

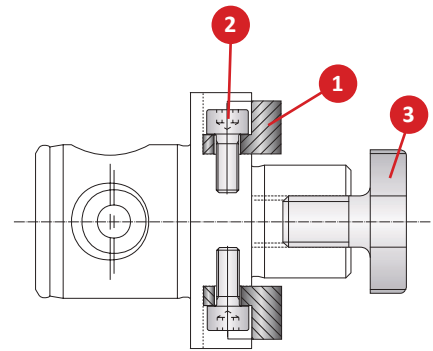

Accessories for Holding Arbors

Adapter Sleeves	Part No.	
	1 Cap Screw	Service Key
209022	115929	s5
209023	115930	s7
209024	115932	s8
209025	115933	s5
209026	115169	s8
209027	115934	s10
209028	115936	s12

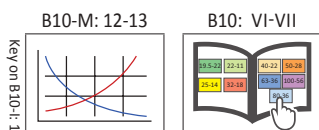
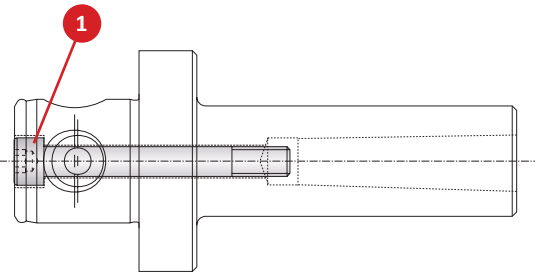

m = Metric (mm)

Reducing Sleeves for Hydraulic Clamping Chucks

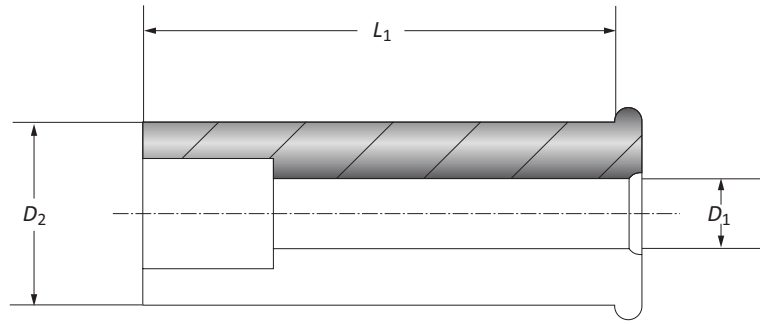

Nominal Size	Reducing Sleeve			Part No.
	D_2	D_1	L_1	
m	20.00	3.00	50.50	271045
	20.00	4.00	50.50	271046
	20.00	5.00	50.50	271047
	20.00	6.00	50.50	271070
	20.00	7.00	50.50	271049
	20.00	8.00	50.50	271004
	20.00	9.00	50.50	271050
	20.00	10.00	50.50	271005
	20.00	11.00	50.50	271051
	20.00	12.00	50.50	271073
	20.00	13.00	50.50	271052
	20.00	14.00	50.50	271074
	20.00	15.00	50.50	271018
	20.00	16.00	50.50	271008

NOTE: For cylindrical shanks with shank tolerance h6 for clamping diameter 3 mm and 8 mm and with shank tolerance h7 for clamping diameter 10 mm - 32 mm.
NOTE: Reduction sleeve with adjustable stop.

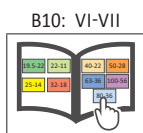
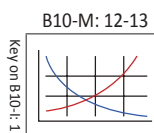

m = Metric (mm)

Quick Change Adapters

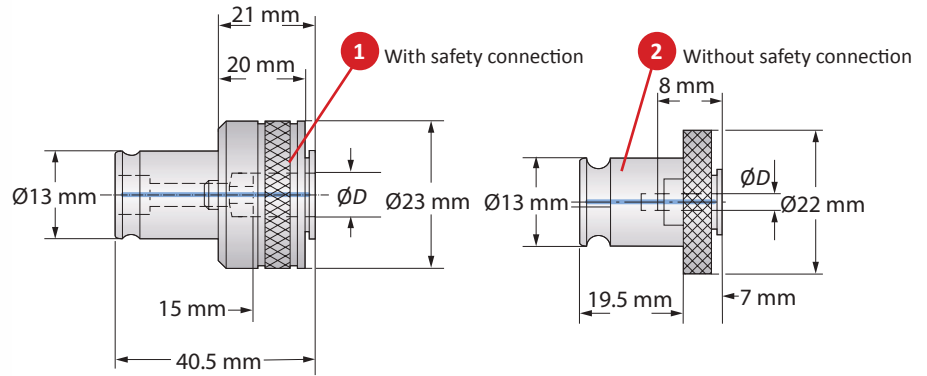

Shank Dimensions		Quick Change Adapter								Part No.	
Nominal Size	D x Square Shank	DIN 352	DIN 353	DIN 371	DIN 374	DIN 376	DIN 2182	DIN 2183	Torque Setting	1	2
0	2.10 x 2.50	M 1	-	M 1	-	M 3.5	1/16"	-	1.5 - 2	233070	K24358
0	2.10 x 2.80	M 2	-	M 2	M 4	M 4	3/32"	5/32"	2 - 3	233071	K24276
0	2.70 x 3.50	M 3	-	M 3	M 5	M 5	1/8"	-	4 - 6	233072	K24277
0	3.00 x 4.00	M 3.5	-	M 3.5	-	-	-	-	1.5 - 2	233073	K24278
0	3.40 x 4.50	M 4	-	M 4	M 6	M 6	5/32"	1/4"	6 - 9	233074	K24279
0	4.90 x 6.00	M 8	-	-	M 8	M 8	-	-	16 - 21	233075	K24280
0	5.50 x 7.00	M 10	G 1/8"	-	M 10	M 10	1/4"	3/8"	27 - 32	233076	K24281
0	6.20 x 8.00	-	-	M 8	-	-	5/16"	7/16"	16 - 21	233077	K24391

NOTE: Quick change adapters are typically set to the torque value shown in the table.

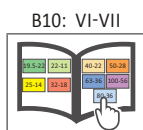
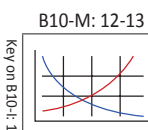

Quick Change Adapters

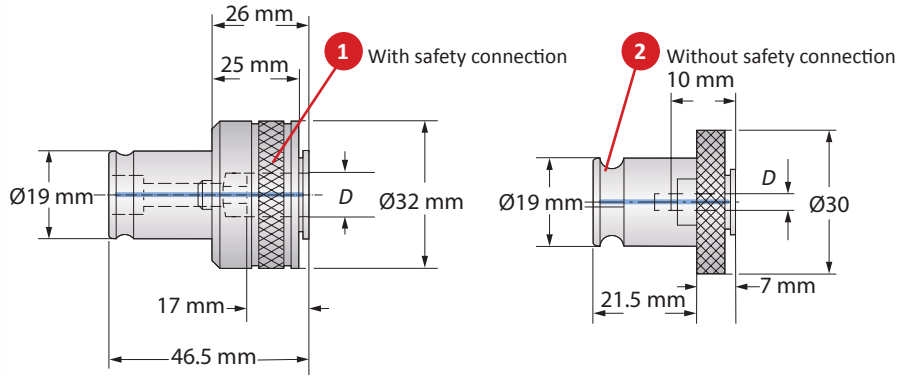

Quick Change Adapters

Shank Dimensions		Quick Change Adapter								Part No.	
Nominal Size	D x Square Shank	DIN 352	DIN 353	DIN 371	DIN 374	DIN 376	DIN 2182	DIN 2183	Torque Setting	1	2
1	2.10 x 2.80	M 2	-	M 2.8	M 4	M 4	3/32"	5/32"	2 - 3	K17847	K23259
1	2.70 x 3.50	M 3	-	M 3.5	M 5	M 5	1/8"	-	4 - 6	233001	K18455
1	3.00 x 4.00	M 3.5	-	M 3.5	-	-	-	-	1.5 - 2	233002	K22439
1	3.40 x 4.50	M 4	-	M 4	M 6	M 6	5/32"	1/4"	6 - 9	233003	K16414
1	4.90 x 6.00	M 8	-	-	M 8	M 8	-	-	16 - 21	233004	K16415
1	5.50 x 7.00	M 10	-	-	M 10	M 10	1/4"	3/8"	27 - 32	233005	K16418
1	6.20 x 8.00	-	G 1/8"	M 8	-	-	5/16"	7/16"	16 - 21	233006	K16416
1	7.00 x 9.00	M 12	-	-	M 12	M 12	3/8"	1/2"	37 - 44	233007	K18454
1	8.00 x 10.00	-	-	M 10	-	-	-	-	27 - 32	233008	K16417
1	9.00 x 11.00	M 14	G 1/4"	-	M 14	M 14	-	9/16"	50 - 53	233009	K22440

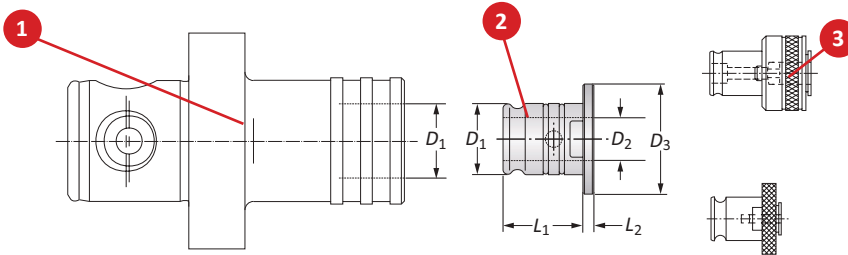

Reducers for Quick Change Adapters

1 Tapping Chuck		2 Quick Change Adapter		3. Reducer					Weight	Part No.
Nominal Size	D ₁	Nominal Size	D ₁	D ₁	D ₂	D ₃	L ₁	L ₂		
1	19.00	0	13.00	19.00	13.00	30.00	21.50	4.00	0.12 (kg)	161038
2	31.00	1	19.00	31.00	19.00	48.00	35.00	5.00	0.48 (kg)	162094

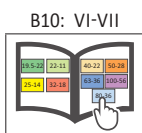
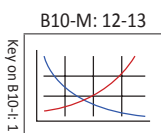

Ⓜ = Metric (mm)

Quick Change Adapters

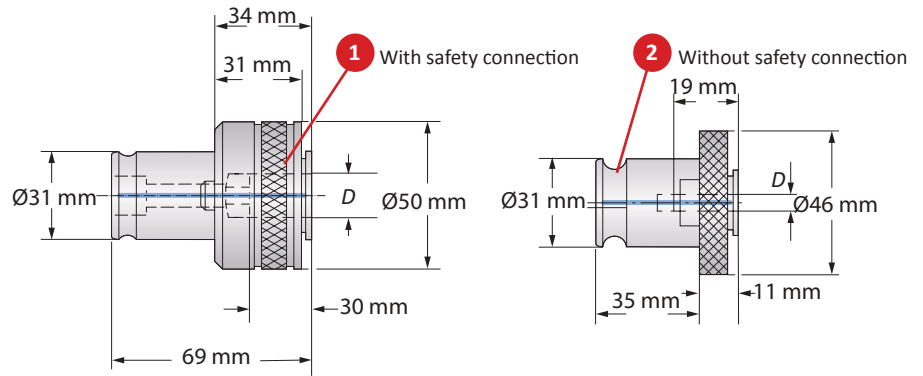

Quick Change Adapters

Shank Dimensions		Quick Change Adapter								Part No.		
Nominal Size	D x Square Shank	DIN 352	DIN 353	DIN 371	DIN 374	DIN 376	DIN 2182	DIN 2183	Torque Setting	1	2	
m	2	5.50 x 7.00	M 10	G 1/8"	-	M 10	M 10	1/4"	3/8"	24 - 32	233020	K15282
	2	6.20 x 8.00	-	-	M 8	-	-	5/16"	7/16"	16 - 21	233021	K15283
	2	7.00 x 9.00	M 12	-	-	M 12	M 12	3/8"	1/2"	37 - 44	233022	K15284
	2	8.00 x 10.00	-	-	M 10	-	-	-	-	27 - 32	233023	K18456
	2	9.00 x 11.00	M 14	G 1/4"	-	M 14	M 14	-	9/16"	50 - 53	233024	K16419
	2	9.00 x 12.00	M 16	G 3/8"	-	M 16	M 16	-	5/8"	55 - 58	233025	K15285
	2	11.00 x 14.00	M 18	-	-	M 18	M 18	-	1 1/16"	85 - 90	233026	K16420
	2	12.00 x 16.00	M 20	G 1/2"	-	M 20	M 20	-	1 3/16"	110 - 115	233027	K15286
	2	14.50 x 18.00	M 24	-	-	M 24	M 24	-	1 5/16"	110 - 115	233028	K18457

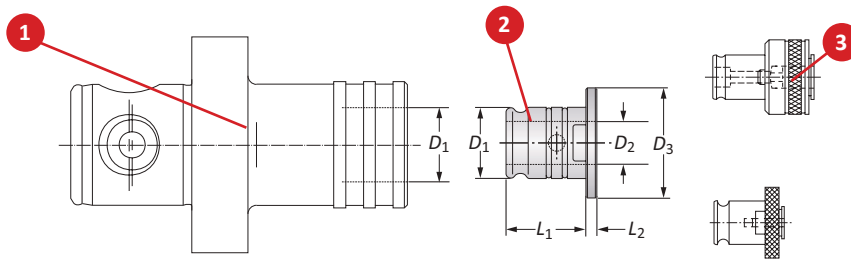

Reducers for Quick Change Adapters

1 Tapping Chuck		2 Quick Change Adapter		3 Reducer					Weight	Part No.	
Nominal Size	D ₁	Nominal Size	D ₁	D ₁	D ₂	D ₃	L ₁	L ₂			
m	1	19.00	0	13.00	19.00	13.00	30.00	21.50	4.00	0.12 (kg)	161038
	2	31.00	1	19.00	31.00	19.00	48.00	35.00	5.00	0.48 (kg)	162094

B10-M: 12-13

B10: VI-VII

Key on B10-I-1

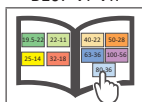
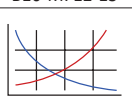

m = Metric (mm)

Quick Change Adapters

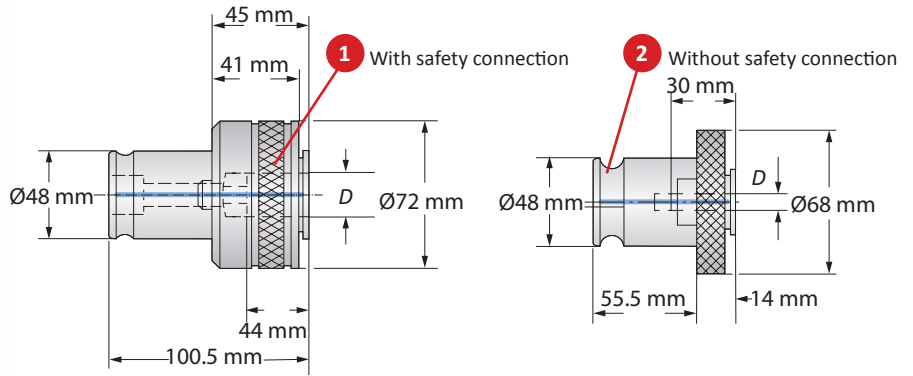

Shank Dimensions		Quick Change Adapters								Part No.		
Nominal Size	D x Square Shank	DIN 352	DIN 353	DIN 371	DIN 374	DIN 376	DIN 2182	DIN 2183	Torque Setting	1	2	
m	3	9.00 x 11.00	M 14	G 1/4"	-	M 14	M 14	-	9/16"	50 - 53	233040	K22434
	3	9.00 x 12.00	M 16	G 3/8"	-	M 16	M 16	-	5/8"	55 - 58	233041	K22435
	3	11.00 x 14.00	M 18	-	-	M 18	M 18	-	11/16"	85 - 90	233042	K22436
	3	12.00 x 16.00	M 20	G 1/2"	-	M 20	M 20	-	13/16"	100 - 106	233043	K22437
	3	14.50 x 18.00	M 24	-	-	M 24	M 24	-	15/16"	140 - 150	233044	K16421
	3	16.50 x 20.00	M 27	G 3/4"	-	M 27	M 27	-	1"	150 - 160	233045	K16422
	3	18.00 x 22.00	M 30	G 7/8"	-	M 30	M 30	-	1 1/8"	240 - 250	233046	K16423
	3	22.00 x 25.00	M 33	G 1"	-	M 33	M 33	-	1 1/4"	260 - 270	233047	K16424
	3	22.00 x 28.00	M 36	G 1 1/8"	-	M 36	M 36	-	1 3/8"	260 - 270	233048	K22438

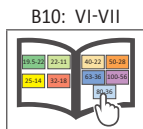
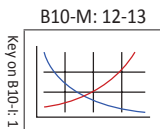

m = Metric (mm)

Service Keys for Collet Systems

Service Keys for ISO 10897 (DIN 6388) Collet Chuck Systems

Service Key			
Nominal Size	Size	Type	Part No.
16	40 - 43	S	068179
25	58 - 62	S	068182
32	68 - 75	S	115867

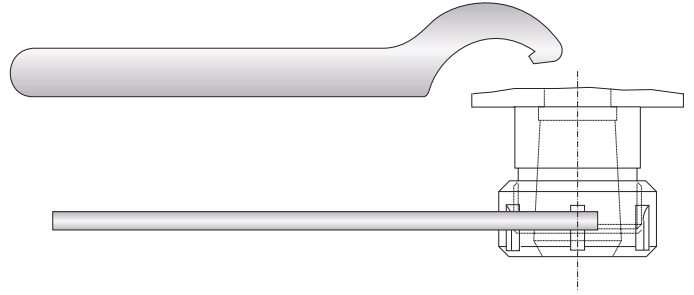

Service Keys for ISO 15488 (DIN 6499) Collet Chuck Systems

Service Key				
Nominal Size	Size	Service Key	Type	Part No.
ER 08 Mini	9.0	-	X	415373
ER 11 Mini	12.0	-	X	415374
ER 16 Mini	17.5	-	X	415375
ER 16	-	25	P	215927
ER 25	42.0	-	T	215929
ER 32	50.0	-	T	215930
ER 40	63.0	-	T	215931



Service Keys for Erickson Collet Chuck Systems

Service Key		
Service Key	Type	Part No.
13	P	315689
19	P	315691

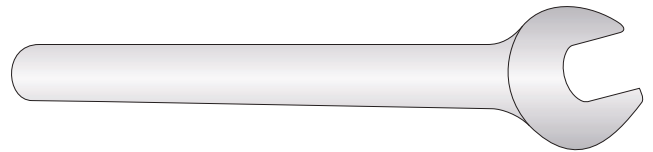

Service Keys for Milling Machine and Holding Arbors

Service Keys	
Service Key	Part No.
13	115785
16	115699
22	115660
27	115661
32	115662
40	115663
60	315637

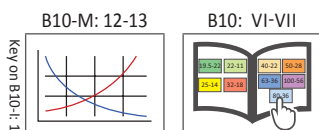
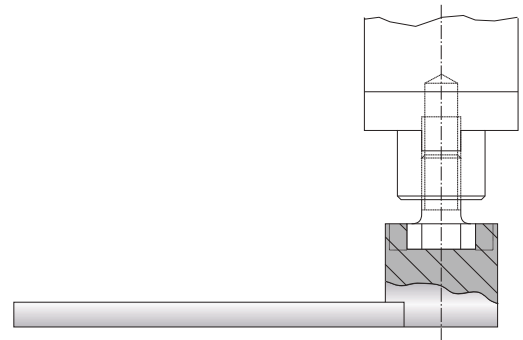

Guaranteed Test / Demo Application Form

Distributor PO #	
------------------	--

The following must be filled out completely before your test will be considered

IMPORTANT: For processing, send purchase order to your Allied Field Sales Engineer (FSE). Please clearly mark the paperwork as "Test Order."

Distributor Information

Company Name: _____
 Contact: _____
 Account Number: _____
 Phone: _____
 Email: _____

End User Information

Company Name: _____
 Contact: _____
 Industry: _____
 Phone: _____
 Email: _____

Current Process List all tooling, coatings, substrates, speeds and feeds, tool life, and any problems you are experiencing

Test Objective List what would make this a successful test (i.e. penetration rate, finish, tool life, hole size, etc.)

Application Information

Hole Diameter: _____ in/mm	Tolerance: _____	Material: _____ (4150, A36, cast iron, etc.)
Pre-existing Diameter: _____ in/mm	Depth of Cut: _____ in/mm	Hardness: _____ (BHN, Rc)
Required Finish: _____ RMS		State: _____ (Casting, hot rolled, forging)

Machine Information

Machine Type: _____ (Lathe, screw machine, machine center, etc.)	Builder: _____ (Haas, Mori Seiki, etc.)	Model #: _____
Shank Required: _____ (CAT50, Morse taper, etc.)		Power: _____ HP/KW
Rigidity: _____	Orientation: _____	Tool Rotating: _____
<input type="checkbox"/> Excellent	<input type="checkbox"/> Vertical	<input type="checkbox"/> Yes
<input type="checkbox"/> Good	<input type="checkbox"/> Horizontal	<input type="checkbox"/> No
<input type="checkbox"/> Poor		Thrust: _____ lbs/N

Coolant Information

Coolant Delivery: _____ (Through tool, flood)	Coolant Pressure: _____ PSI / bar
Coolant Type: _____ (Air mist, oil, synthetic, water soluble, etc.)	Coolant Volume: _____ GPM / LPM

Requested Tooling

QTY	Item Number

QTY	Item Number

engineering.eu@alliedmachine.com

Allied Machine & Engineering Co. (Europe) Ltd
 93 Vantage Point, Pensnett Estate,
 Kingswinford, DY6 7FR, United Kingdom

+44 (0)1384 400 900
www.alliedmachine.com



ALLIED MACHINE & ENGINEERING



WOHLHAUPTER
 Holmaking Solutions for Today's Manufacturing



ALLIED MACHINE & ENGINEERING

Warranty Information



Allied Machine & Engineering (“Allied Machine”) warrants to original equipment manufacturers, distributors, industrial and commercial users of its products for one year from the original date of sale that each new product manufactured or supplied by Allied Machine shall be free from defects in material and workmanship.

Allied Machine’s sole and exclusive obligation under this warranty is limited to, at its option, without additional charge, replacing or repairing this product or issuing a credit. For this warranty to be applied, the product must be returned freight prepaid to the plant designated by an Allied Machine representative and which, upon inspection, is determined by Allied Machine to be defective in material and workmanship.

Complete information as to operating conditions, machine, setup, and the application of cutting fluid should accompany any product returned for inspection. This warranty shall not apply to any Allied Machine products which have been subjected to misuse, abuse, improper operating conditions, improper machine setup or improper application of cutting fluid or which have been repaired or altered if such repair or alteration, in the judgement of Allied Machine, would adversely affect the performance of the product.

THIS WARRANTY IS IN LIEU OF ALL OTHER WARRANTIES, EXPRESS OR IMPLIED, INCLUDING ANY IMPLIED WARRANTY OF MERCHANTABILITY OR FITNESS FOR A PARTICULAR PURPOSE. Allied Machine shall have no liability or responsibility for any claim, whether in contract, tort or otherwise, for any loss or damage arising out of, connected with, or resulting from the manufacture, sale, delivery or use of any product sold hereunder, in excess of the cost of replacement or repair as provided herein.

Allied Machine shall not be liable in contract or in tort (including, without limitation, negligence, strict liability or otherwise) for economic losses of any kind or for any special, incidental, indirect, consequential, punitive or exemplary damages arising in any way out of the performance of, or failure to perform this agreement.

ALL PRICES, DELIVERIES, DESIGNS, AND MATERIALS ARE SUBJECT TO CHANGE WITHOUT NOTICE.



Allied Machine & Engineering Co. Europe Ltd. is registered to ISO 9001:2015 by bsi.



Allied Machine & Engineering is registered to ISO 9001:2015 by DQS



Wohlhaupter GmbH is registered to ISO 9001:2015 by GA TECHNIC

Europe

Allied Machine & Engineering Co. (Europe) Ltd.

93 Vantage Point
Pensnett Estate
Kingswinford
West Midlands
DY6 7FR England

Phone:

+44 (0) 1384.400900

Wohlhaupter® GmbH

Maybachstrasse 4
Postfach 1264
72636 Frickenhausen
Germany

Phone:

+49 (0) 7022.408.0

United States

Allied Machine & Engineering

120 Deeds Drive
Dover OH 44622
United States

Phone:

+1.330.343.4283

Toll Free USA and Canada:

800.321.5537

Toll Free USA and Canada:

800.223.5140

Allied Machine & Engineering

485 W Third Street
Dover OH 44622
United States

Phone:

+1.330.343.4283

Toll Free USA and Canada:

800.321.5537

Asia

Wohlhaupter® India Pvt. Ltd.

B-23, 3rd Floor
B Block Community Centre
Janakpuri, New Delhi - 110058
India

Phone:

+91 (0) 11.41827044

Your local Allied Machine representative:

www.alliedmachine.com

Allied Machine & Engineering Co. (Europe) Ltd is registered to **ISO 9001:2015** by bsi.

Allied Machine & Engineering is registered to **ISO 9001:2015** by DQS

Wohlhaupter GmbH is registered to **ISO 9001:2015** by QTA TECHNIC

